



Rocky Mountain Metals, Inc

Manufacturer of Standard and Custom Hollow
Metal Doors, Frames and Windows

Index

Introduction	3
List of References	
Educational	4-5
Medical Care	6
Municipal, Military and Governmental	7
Corporate, Retail and Commercial	8
Hotels	9
Libraries and Casinos	10
Hollow Metal Doors	
General Information	11
Door Details	12
1100 Polystyrene Core	13
1200 Steel Stiffened	14
1500 Lead Lined	14
1300 Temperature Rise	15
1600 Dutch Doors	16-17
Hollow Metal Frames	
General Information	18-19
Welded Frames	20
Knockdown (KD) Frames	21
Pocket Frames	22
Custom Frames	23-24
Tornado Resistant Opening	25
1400 FEMA Frame and Shutter	26-27
1400 FEMA Door and Shutter	28
Bullet Resistant Opening	
1701 Level 1 Polystyrene Door	29
1703 Level 3 Polystyrene Door	32
Welded Frames for Bullet Resistant Doors	
1701 and 1801	31
1801 Level 1 Steel Stiffened	32
1803 Level 3 Steel Stiffened	30
Welded Frames for Bullet Resistant Doors	
1703 and 1803	34
Ballistic Anchors	35
Leadership in Energy and Environmental Design	36
Contact Information	37
Buy America Act	38
Certifications	38



Rocky Mountain Metals, Inc., is a manufacturer of Standard and Custom Hollow Metal Door and Frame Products located in Raton, New Mexico, just south of the Colorado border. Established in 1988, the company has over the years, supplied hollow metal products to numerous types of facilities from small offices and schools, to prestigious corporate headquarters, hospitals and exclusive hotels.

We offer excellent service with short lead times and very competitive prices. Customized and quick quoting as well as order processing through our knowledgeable and experienced staff. By the attached references, we hope that you get an understanding of not only our capabilities, but also that we are dependable and reliable. A partner you can count on.

Rocky Mountain Metals, Inc. is continually expanding capabilities, improving efficiencies and upgrading production facilities to meet today's high standards for quality and customer service. Our product program consists of among others:

Hollow Metal Frames

- Face and fully welded door and window frames. From standard frames to complex customized frame configurations. If you can design it, we can build it
- Lead lined door and window frames
- Knock down frames for welding and drywall applications
- Pocket frames

Hollow Metal Doors

- Polystyrene core construction
- Steel stiffened doors
- Lead lined doors
- Temperature rise doors
- Dutch doors

Openings Solutions

Classified to FEMA P-361 (2015) and certified to ICC 500 (2014)

Bullet Resistant Openings

Classified to UL 752 Levels 1 and 3

Labeling and fire rating under the procedures from Underwriters Laboratory (UL). Rocky Mountain Metals, Inc. is authorized to label three-sided frames and doors for up to three hours and sidelights and windows for up to 90 minutes.

All our products qualify for full LEED Credits for recycled content MR.4.1 and 4.2, as they contain more than 25% recycled material as per the LEED Definitions (100% of Post Consumer and 50% of Pre Consumer Recycled Content).

We are a member of the **National Association of Architectural Metal Manufacturers (NAAMM)** and **Hollow Metal Manufacturers Association (HMMA)**. **Our products are manufactured in accordance with the applicable HMMA Standards** such as HMMA 802-07 "Manufacturing of Hollow Metal Doors and Frames" and HMMA 841-07 "Tolerances and Clearances for Commercial Hollow Metal Doors and Frames". Consequently, as per these standards, we meet and or exceed the applicable ANSI/SDI criteria.

We have an experienced management team in place with solid Hollow Metal background, as well as, experience from top level positions in the Door and Hardware Industry in the US and internationally.

Please take the time to review the information in this brochure to get a better understanding of our products and services we can provide. I hope that you will find this helpful enough to give us a chance to show what we can do for you in the areas of Standard and Custom Hollow Metal.

Sincerely yours,

Clas Thelin
President
cthelin@rockymountainmetals.com

**Rocky Mountain Metals, Inc. is the proud supplier of
hollow metal doors, frames and/or windows for these projects
Educational Facilities - Suitable solutions for any level**

Over the years we have supplied doors and frames to educational facilities all over the country. From small basic school facilities to state of the art universities and colleges. Our product program is constantly under development to cater to the ever changing life safety needs in this area. Additionally, our products are frequently used where complex and highly customized hollow metal solutions are chosen.

Saks High School **(FEMA)**
 Marionneaux Elementary School
 Campo Bello ISD
 Greenway High School
 Thunderbird High School
 Tramonto Ridgeline Academy
 Western School of Science and Technology
 Dorothy ISD Elementary
 Mammoth Middle School
 San Diego State University
 Cherry Creek Middle School #11
 Lemay Academy
 Denver Public Schools—Paul Sandoval Campus
 Dakota Ridge State University
 American Academy
 Londonderry Elementary School
 Dodge City High School USD 443
 Sunnyside Elementary School
 Unified School District #443 Soule Elementary
 Hoisington USD 431
 Lincoln Elementary School
 Scott City Middle School

Boulder City High School
 Andre Agassi College Prep Academy
 Clifford J. Lawrence Jr. High
 Hollingsworth Elementary School
 Linda Rankin Givens Elementary School
 Palo Verde High School
 Petersen Elementary School
 Rancho High School
 UNLV Campus
 Atrisco Elementary School
 Rio Grande High School
 University of New Mexico Farris Engineering
 Fort Wingate Elementary School
 New Mexico State University Grants
 Hobbs Schools
 Jal Public Schools
 Santa Fe Indian School
 West Las Vegas Middle School
 Jackson Elementary School **(FEMA)**
 Okarcho Public Schools **(FEMA)**
 Woodard Schools **(FEMA)**
 University of Rhode Island-College of Pharmacy

Anniston, AL
 Buckeye, AZ
 Phoenix, AZ
 Phoenix, AZ
 Phoenix, AZ
 Phoenix, AZ
 Phoenix, AZ
 Yuma, AZ
 Mammoth Lakes, CA
 San Diego, CA
 Aurora, CO
 Colorado Springs, CO
 Denver, CO
 Littleton, CO
 Parker, CO
 Peyton, CO
 Dodge City, KS
 Dodge City, KS
 Dodge City, KS
 Hoisington, KS
 Hoisington, KS
 Hoisington, KS
 Scott City, KS

Boulder City, NV
 Las Vegas, NV
 Las Vegas, NV
 Las Vegas, NV
 Las Vegas, NV
 Las Vegas, NV
 Las Vegas, NV
 Las Vegas, NV
 Las Vegas, NV
 Las Vegas, NV
 Albuquerque, NM
 Albuquerque, NM
 Albuquerque, NM
 Fort Wingate, NM
 Grants, NM
 Hobbs, NM
 Jal, NM
 Santa Fe, NM
 Las Vegas, NM
 Las Vegas, NM
 Oklahoma City, OK
 Okarcho, OK
 Woodard, OK
 Kingston, RI



**New Mexico State University
Grants, New Mexico**

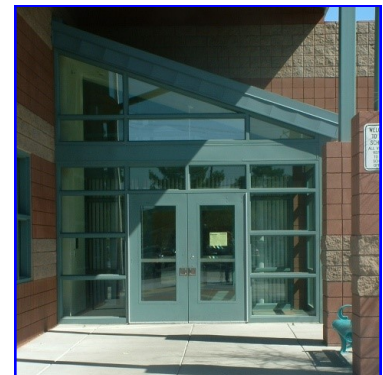

**Petersen Elementary School
Las Vegas, NV**

More Educational listings are on the next page!

Rocky Mountain Metals, Inc. is the proud supplier of hollow metal doors, frames and/or windows for these projects

Educational Facilities - Suitable solutions for any level

Over the years we have supplied doors and frames to educational facilities all over the country. From small basic school facilities to state of the art universities and colleges. Our product program is constantly under development to cater to the ever changing life safety needs in this area. Additionally, our products are frequently used where complex and highly customized hollow metal solutions are chosen.

Adrian Independent School District
 Canyon Independent School District (FEMA)
 River Road Independent School District
 Arlington ISD
 Mansfield ISD Multi Purpose Center
 Harmony Science Academy Cedar Park
 Borger ISD Stadium
 Bovina ISD
 Carthage ISD Admin
 Antonian College Preparatory High School
 JFK Elementary School
 Lubbock Cooper Independent School District
 Colleyville Heritage High School
 Crowley ISD
 George W. Truett Elementary School
 Decatur Elementary School
 Dimmitt High School & Middle School
 Dimmitt ISD Elementary School (FEMA)
 Everman Joe C Bean High School
 Forest Hills Prep
 TCU Annie Richardson Bass Building
 Frenship New Elementary School
 Sam Houston Elementary School
 Georgetown High School
 United Independent School District
 University of Texas Health Science Center
 ASU Archer College of Health and Human Svcs
 Texas Tech University—Architectural Bldg.
 Texas Tech University Horn Hall
 Texas Tech University Sports Performance Center
 Alice Ponder Elementary School
 Brooks Wester Middle School
 Glenn Harmon Elementary School
 J L Boren Elementary School
 Rogene Worley Middle School
 Barbara Fasken Elementary School
 Bynum Schools
 Southwest Elementary School
 Odessa College Sewell Auto Tech
 Texas Tech University—Permian Basin Academy
 Angelo State University—Greenhouse
 Angelo State University—Hunter Strain Engineering
 Austin Elementary
 BASIS San Antonio North Central
 Judith A. Resnik Elementary School
 Tahoka ISD
 Taylor Independent School District
 Tivoli ISD
 Boulter Middle School
 Venus Middle School
 Southwest Legacy High School
 North Elementary School
 Winnsboro ISD High School

Adrian, TX
 Amarillo, TX
 Amarillo, TX
 Arlington, TX
 Arlington, TX
 Austin, TX
 Borger, TX
 Bovina, TX
 Carthage, TX
 Castle Hills, TX
 Corpus Christi, TX
 Cedar Park, TX
 Colleyville, TX
 Crowley, TX
 Dallas, TX
 Decatur, TX
 Dimmitt, TX
 Dimmitt, TX
 Everman, TX
 Fort Worth, TX
 Fort Worth, TX
 Wolfforth, TX
 La Feria, TX
 Georgetown, TX
 Laredo, TX
 Laredo, TX
 Lubbock, TX
 Lubbock, TX
 Lubbock, TX
 Lubbock, TX
 Mansfield, TX
 Mansfield, TX
 Mansfield, TX
 Mansfield, TX
 Mansfield, TX
 Midland, TX
 Midland, TX
 Midland, TX
 Odessa, TX
 Odessa, TX
 San Angelo, TX
 San Angelo, TX
 San Angelo, TX
 San Antonio, TX
 San Antonio, TX
 Tahoka, TX
 Taylor, TX
 Tivoli, TX
 Tyler, TX
 Venus, TX
 Von Ormy, TX
 White Settlement, TX
 Winnsboro, TX



**Texas Christian University
 Annie Richardson Bass Building
 Fort Worth, TX**



**Texas Tech University
 Sports Performance Center
 Lubbock, TX**

Rocky Mountain Metals, Inc. is the proud supplier of hollow metal doors, frames and/or windows for these projects

Medical Care Facilities - From clinics to full size hospitals

The width of our products as well as our capability to supply anything from a simple door opening to custom hollow metal configurations of almost any size and complexity has made us a favored choice when it comes to medical care facilities. We can competitively supply products and solutions on all different levels, from a small clinic to full scale hospitals like the VA Hospital in Denver and Walter Reed Army Medical Center. This has gained us substantial expertise in the special products and needs in this area.



**Walter Reed Medical Center
Bethesda, MD**

- | | |
|----------------------------------|----------------------|
| Mayo Clinic | Scottsdale, AZ |
| Perimeter Hospital (FEMA) | Scottsdale, AZ |
| Banner Estrella Medical Center | Phoenix, AZ |
| Banner University Medical Center | Tuscon, AZ |
| Clovis Community Medical Center | Clovis, CA |
| Veterans Affairs Hospital | Aurora, CO |
| Peterson Dental Clinic | Colorado Springs, CO |
| Code 3ER and Urgent Care | Denton, TX |
| D.I. Medical and Research Center | Denver, CO |
| Mercy Medical Life Safety | Denver, CO |
| Poudre Valley Hospital | Denver, CO |
| Greely Hospital | Greely, CO |
| Sterling Medical Center | Sterling, CO |
| St. Catherine Cancer Center | Garden City, KS |
| Colvin Family Center | Liberal, KS |
| Osborne County Memorial Hospital | Osborne, KS |

- | | |
|---------------------------------------|------------------|
| Annapolis Health Clinic | Annapolis, MD |
| Walter Reed Army Medical Center | Bethesda, MD |
| Walter Reed Behavioral Health | Bethesda, MD |
| Eye Surgery of Nebraska | North Platte, NE |
| Gallup Indian Medical | Gallup, NM |
| Green Valley Chiropractic & Wellness | Henderson, NV |
| Henderson Hospital | Henderson, NV |
| Mountain View Hospital | Las Vegas, NM |
| Mountain View Regional Medical | Las Vegas, NV |
| Sunrise Hospital | Las Vegas, NV |
| UMC Trauma Center | Las Vegas, NV |
| Behavioral Health Clinic | Fort Brigg, NC |
| Eufaula Indian Health (FEMA) | Eufaula, OK |
| Comanche County Memorial Hospital | Lawton, OK |
| Connors State Allied Health & Nursing | Muskogee, OK |
| Hendrick Medical Center | Abilene, TX |
| Texas Rehabilitation Hospital | Arlington, TX |
| Ambulatory Surgery | Amarillo, TX |
| Northwest Texas Hospital S.P. | Amarillo, TX |
| Wolflin Medical Center | Amarillo, TX |
| Matagonda Hospital | Bay City, TX |
| Scenic Mountain Medical | Big Spring, TX |
| Harmony Science Center | Cedar Park, TX |
| Presbyterian Hospital | Denton, TX |
| Cobalt Medical | El Paso, TX |
| Forest Park Medical Center | Fort Worth, TX |



**Georgetown Behavioral
Health Institute
Georgetown, TX**

- | | |
|-------------------------------------|---------------------|
| Mesa Springs Hospital | Fort Worth, TX |
| Sundance Psychiatric Hospital | Garland, TX |
| Georgetown Behavioral Health Inst . | Georgetown, TX |
| Greystar Texas Medical Center | Laredo, TX |
| Caprock Cardiovascular | Lubbock, TX |
| Community Health Center | Lubbock, TX |
| South Plains Rehab Hospital | Lubbock, TX |
| West Texas Eye Associates | Lubbock, TX |
| J Cleo Wellness Center | Ozona, TX |
| Seminole Hospital | Seminole, TX |
| Montezuma Creek Health | Montezuma Creek, UT |
| CWC Health Science | Riverton, WY |

Rocky Mountain Metals, Inc. is the proud supplier of hollow metal doors, frames and/or windows for these projects

Municipal, Military and Governmental Facilities - Security and Safety

In today's society security and safety are top priorities for most municipal, military and governmental facilities. We are proud of the confidence that our customers put on us and our ability to provide this for different openings and other hollow metal solutions. With a strong base in the Colorado, Texas and Nevada areas we have also been trusted to provide supply our products to other areas.

Butler City Hall **(FEMA)**
 Fort McClellan Army National Training Center **(FEMA)**
 Butler City Hall
 Eutaw 911 Building **(FEMA)**
 OCC Electric Center
 Davis-Monthan AFB-Aerospace Maintenance & Regeneration Group
 F-35 Squadron Ops
 Alamosa County Justice
 Aurora Justice Center
 Buckley AFB, Bldg. 909
 4th ID CAB Consolidated Battalion HQ
 Company Operations Facility
 Division Headquarters
 Mountain View Ops
 Visiting Officers Quarters
 ABQ Bio Park
 New Mexico Game and Fish
 Bernalillo Senior Center
 Cannon AFB
 McKinley County Justice Complex
 German Air Facility
 National Security and Science Building
 Taos County Administration and Detention
 Cold Creek Prison
 Clark County Detention Center
 Federal Justice Tower
 Juvenile Treatment Facility
 Las Vegas Metropolitan Police Department
 Las Vegas Metropolitan PD – Fingerprint Bureau
 Regional Justice Center
 Visiting Officers Quarters
 Lovelock Prison
 Oklahoma Turnpike Authority **(FEMA)**
 Chemical Science Building
 Visiting Officers Quarters
 Sheppard Air Force Base
 USPS Distribution Center
 Unites States Postal Facility
 Abilene Zoo
 Potter County Law **(FEMA)**
 Cisco Water Treatment
 Social Security Office of Disability and Adjudication
 Visiting Officers Quarters
 DFW Airport Terminal E
 Flower Mound Town Hall
 West Memorial Place
 Lovington Fire Station
 Midland Municipal Courts
 AEP Service
 Bexar Metro 911 Call Center **(FEMA)**
 MCESD #8 Fire Station **(FEMA)**
 Bayside Community Center

Anniston, AL
 Anniston, AL
 Butler, AL
 Eutaw, AL
 Selma, AL
 Davis-Monthan AFB, AZ

 Luke AFB, AZ
 Alamosa, CO
 Aurora, CO
 Colorado Springs, CO
 Fort Carson, CO
 Fort Carson, CO
 Fort Carson, CO
 Buckley AFB, Aurora, CO
 Peterson AFB, CO
 Albuquerque, NM
 Albuquerque, NM
 Bernalillo, NM
 Clovis, NM
 Gallup, NM
 Holloman AFB, NM
 Los Alamos, NM
 Taos, NM
 Indian Springs, NV
 Las Vegas, NV
 Las Vegas, NV
 Las Vegas, NV
 Las Vegas, NV
 Las Vegas, NV
 Las Vegas, NV
 Nellis AFB, NV
 Lovelock, NV
 Oklahoma City, OK
 Tinker AFB, OK
 Altus AFB, OK
 Norman, OK
 Portland, OR
 Nashville, TN
 Abilene, TX
 Amarillo, TX
 Cisco, TX
 Dallas, TX
 Dyess AFB, TX
 Dallas Ft. Worth, TX
 Flower Mound, TX
 Houston, TX
 Lubbock, TX
 Midland, TX
 San Angelo, TX
 San Antonio, TX
 Spring, TX
 Tomball, TX



**Clark County Detention Center
Las Vegas, NV**



**Federal Justice Tower
Las Vegas, NV**

Rocky Mountain Metals, Inc. is the proud supplier of hollow metal doors, frames and/or windows for these projects

Religious, Corporate, Retail and Commercial Buildings Image and Cost Efficiency

When it comes to religious, corporate, retail and commercial buildings the top priorities are most often image and cost efficiency. You want to be able communicate strength and success but at the same keep things under pretty tight cost control. We have been trusted to support in these efforts by a number of very successful companies.

Arvest Data Center **(FEMA)**
 Agua Fria Assisted Living
 Yoga
 Bank of Colorado
 Ronald McDonald House
 Rush Truck Center
 Village at the Peaks
 Starbucks Coffee **(FEMA)**
 Switch NSP 01 **(FEMA)**
 ABC Studios
 Ocean Spray III
 Bonnie Lane Senior Housing
 Hilton Executive Offices
 Switch Super NAP 8 Data Center
 Veer Towers at City Center
 Bohannon Huston
 Intel Headquarters – Water Plant
 Mesa Microlab
 UNM Pais
 Christian Center Church
 Wellbrook Senior Living
 Weapons Integration Facility
 Raiders Stadium
 Discount Tire Store **(FEMA)**
 Discount Tire Store **(FEMA)**
 Discount Tire Store **(FEMA)**
 HUB
 National Cowboy Hall of Fame
 Villas of the Benedictine
 Discount Tire Store **(FEMA)**
 Discount Tire Store **(FEMA)**
 Affiliated Foods
 Alpha Building Corporation
 Amarillo Recovery from Alcohol and Drugs
 Cinergy Entertainment Group
 Potter County Law **(FEMA)**
 Wiley Hicks, JR
 Benbrook Animal Shelter
 Harley Davidson
 KPMG Plaza at Hall Arts
 Sts. Peter and Paul Catholic Church
 Chase Building
 Alcon Labs
 Facebook Data Center **(FEMA)**
 Pier One Headquarters
 Merrick Pet Foods
 Energy Plaza
 Riva at the Park Condominiums
 West Memorial Place
 Alliance Credit Union
 American National Bank
 Cabela's
 XTO Energy Office
 Helmerich & Payne Facility Expansion
 St. Martin De Porres Catholic Church
 Discount Tire Store **(FEMA)**
 TJ Maxx
 Graystar TMC
 Discount Tire Store **(FEMA)**

Rogers, AR
 Peoria, AZ
 Aspen, CO
 Colorado Springs, CO
 Colorado Springs, CO
 Commerce, CO
 Longmont, CO
 Augusta, GA
 Atlanta, GA
 New York, NY
 Henderson, NV
 Las Vegas, NV
 Las Vegas, NV
 Las Vegas, NV
 Las Vegas, NV
 Albuquerque, NM
 Albuquerque, NM
 Albuquerque, NM
 Albuquerque, NM
 Hobbs, NM
 Las Cruces, NM
 Los Alamos, NM
 Las Vegas, NV
 Barlesville, OK
 Bixby, OK
 Enid, OK
 Tulsa, OK
 Oklahoma City, OK
 Oklahoma City, OK
 Shawnee, OK
 Sumter, SC
 Amarillo, TX
 Amarillo, TX
 Amarillo, TX
 Amarillo, TX
 Amarillo, TX
 Amarillo, TX
 Benbrook, TX
 Dallas, TX
 Dallas, TX
 Dumas, TX
 Farmers Branch, TX
 Fort Worth, TX
 Fort Worth, TX
 Fort Worth, TX
 Hereford, TX
 Houston, TX
 Houston, TX
 Houston, TX
 Houston, TX
 Lubbock, TX
 Lubbock, TX
 Lubbock, TX
 Midland, TX
 Odessa, TX
 Prosper, TX
 San Antonio, Tx
 San Antonio, TX
 Tomball, TX
 Tyler, TX



**Switch SuperNAP 8
Las Vegas, NV**



**West Memorial Place
Houston, TX**



**KPMG Plaza at Hall Arts
Dallas, TX**

Rocky Mountain Metals, Inc. is the proud supplier of hollow metal doors, frames and/or windows for these projects

Hotels - Hospitality and comfort coupled with safety and security

With Nevada and Texas as a base, we are a trusted supplier to the hospitality industry. We have a proven track record to be able to support our customers need to provide a high level of comfort but at the same time not compromise the safety and security for their guests. Our products show up in a number of very prestigious facilities and also in more cost conscious environments.

- Hyatt
- Ritz Carlton
- Adam's Mark Hotel
- Vail Marriott
- The Miami Beach EDITION Hotel
- Springhill Suites
- Marriott
- Embassy Suites
- Hampton Inn
- Howard Hughes Parkway
- Mirage Hotel Theater Center
- Polo Twin Towers
- Hilton Garden Inn
- Winstar Hotel and Casino
- Fifth Season Inn
- Marriott North
- Marriott South
- Marriott
- Hilton Garden Inn
- Marriott
- Marriott
- Townplace Suites
- Sedona, AZ
- San Francisco, CA
- Denver, CO
- Vail, CO
- Miami, FL
- Kansas City, KS
- Olathe, KS
- Las Vegas, NV
- Las Vegas, NV
- Las Vegas, NV
- Las Vegas, NV
- Las Vegas, NV
- Oklahoma City, OK
- Thackerville, OK
- Amarillo, TX
- Austin, TX
- Austin, TX
- Ft. Worth, TX
- Lubbock, TX
- Odessa, TX
- Plano, TX
- Vernal, UT



The Miami Beach Edition Hotel, Miami, FL



Hyatt, Sedona, AZ



Ritz Carlton, San Francisco, CA



Marriott, Vail, Colorado

Rocky Mountain Metals, Inc. is the proud supplier of hollow metal doors, frames and/or windows for these projects

Libraries - Serenity and design

We are proud of the trust we have been shown and the opportunity we have been given to be part of the more prestigious libraries in the country. These are buildings where design and the feel of serenity are top priorities and it is certainly prestigious for a hollow metal company like Rocky Mountain Metals to support this.

JFK Library
Lied Library
Arlington Central Library
TCU Mary Couets Burnett Library

Boston, MA
Las Vegas, NV
Arlington, TX
Fort Worth, TX

**JFK Library
Boston, MA**



Casinos - Money, money, money...

Our base in Las Vegas has provided us with ample opportunities to supply products to some of the most prestigious casinos in the world. Our products have proven to provide the right level of security and aesthetics to cater to this demanding market.



**Caesar's Palace
Las Vegas, NV**

**The Orleans Hotel and Casino
Las Vegas, NV**

Bally's Casino	Las Vegas, NV
Boardwalk Casino	Las Vegas, NV
Caesar's Palace	Las Vegas, NV
MGM Grand – Theatre	Las Vegas, NV
The Orleans Hotel and Casino	Las Vegas, NV
Stratosphere	Las Vegas, NV
Sunrise Casino	Las Vegas, NV
Treasure Island Casino	Las Vegas, NV
Winstar Hotel and Casino	Thackerville, OK



Hollow Metal Doors

A full line of Hollow Metal Doors

- 1100 Doors with Polystyrene Core
- 1200 Steel Stiffened Doors
- 1300 Temperature Rise Doors
- 1400 Doors for Tornado Solutions
- 1500 Lead lined Doors
- 1600 Dutch Doors

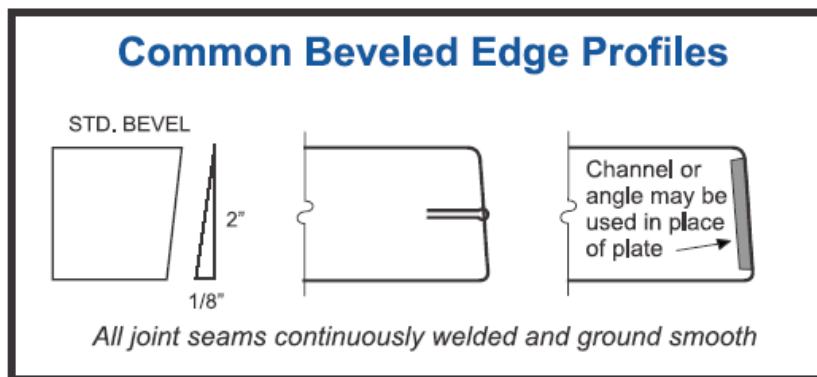
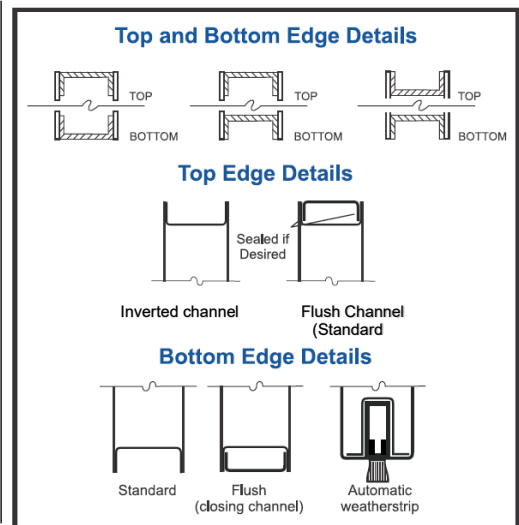
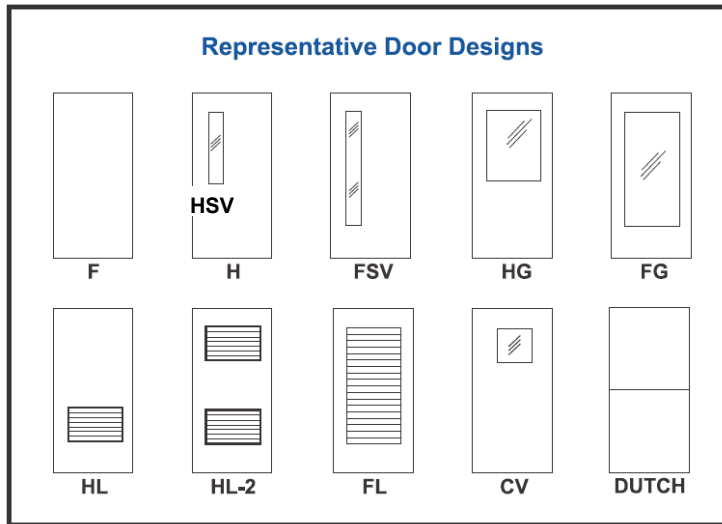

Manufacturing Tolerances

Manufacturing tolerances shall be maintained within the following limits for Doors

Width +/- 1/32 in. (.08mm)

Height +/- 3/64 in. (1.2mm)

Thickness +/- 1/16 in. (1.6mm)

Hardware cutout dimensions/Template dimensions +0.015", -0"

Hardware location +/- 1/32 in. (.08mm)

Door Details - Typical Hardware Preparations

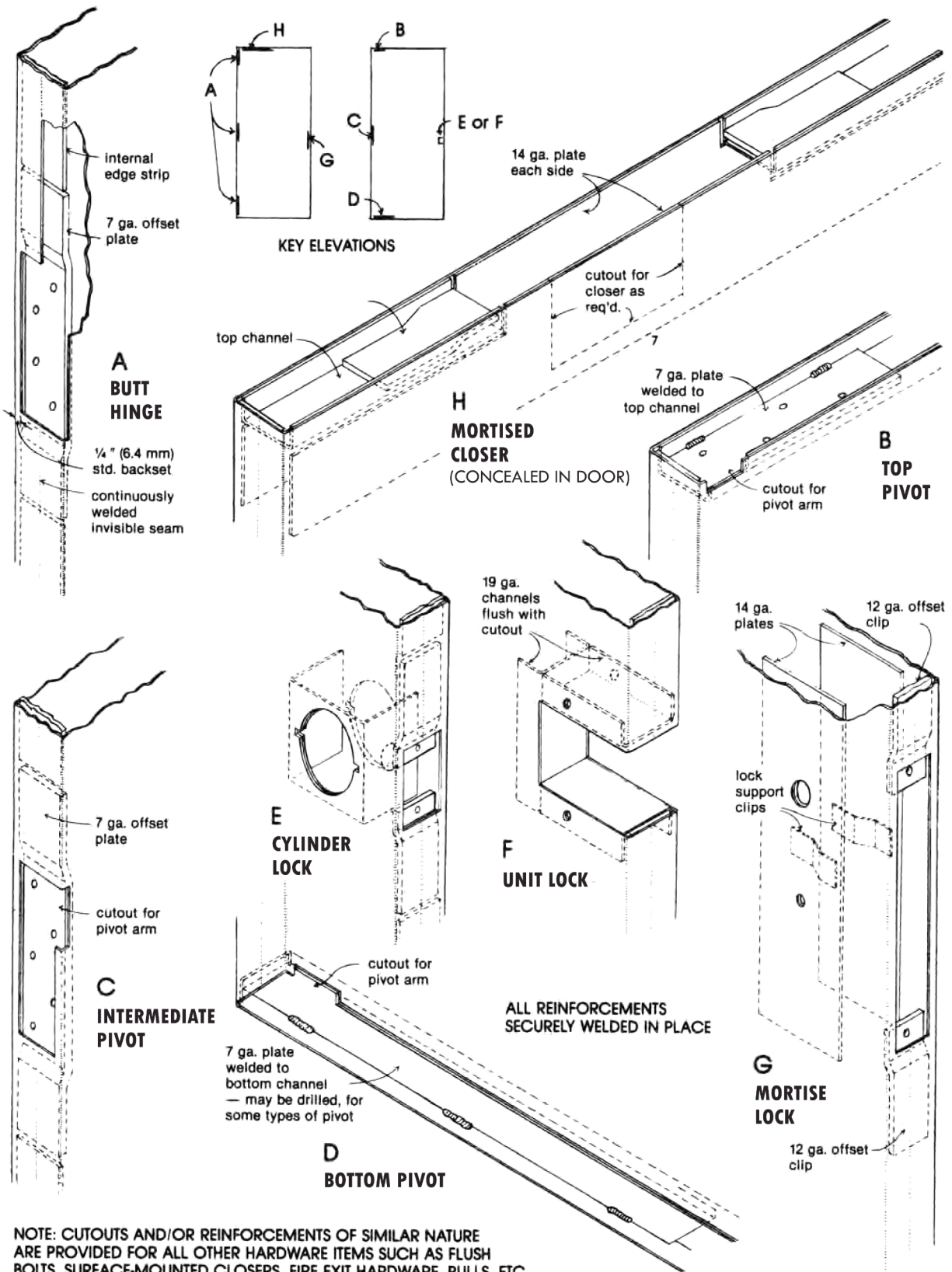

1100 Hollow Metal Door with Polystyrene Core/Fire Rated

Face Material	Galvannealed A40 or A60 ASTM-A-653
Face thickness	12, 14, 16 and 18 Ga.
Construction	Rigid polystyrene core bonded to both face sheets
Door thickness	1 3/4" Standard
Hardware Locations	Any specified locations
Reinforcements	7 Ga. 1 1/4" x 10" joggled hinge reinforcement, drilled and tapped 12 Ga. mortise hardware tabs, drilled and tapped 14 Ga. surface hardware and trim reinforcement
Edge reinforcement	Both edges reinforced with 16 Ga. full length channels spot welded to the face sheets
Vertical edges	Fully welded with no visible seam (for doors up to 4' wide and 8' height)
Glazing/ Louvers	Glazing stops to be set for 1/4" glass (3/8" space) unless otherwise requested. Note: Glass should be cut 1/4" less than door cut out. Exposed glass opening is 1 5/16" less than cutout dimensions. Louver size is actual size of door cutout
Handing	Doors are handed
Appearance	Faces and edges free of defects, warp and buckle
Finish	Thoroughly cleaned and coated with a rust inhibiting primer meeting requirements as per ANSI/SDI A250.10
Fire Rated	3 ft. wide, 7ft. High doors can be manufactured fire rated up to 3 hours. Hardware can be mortise or cylindrical locks. Mortise or rim type fire exit hardware. Surface mounted vertical rod type fire exit hardware.

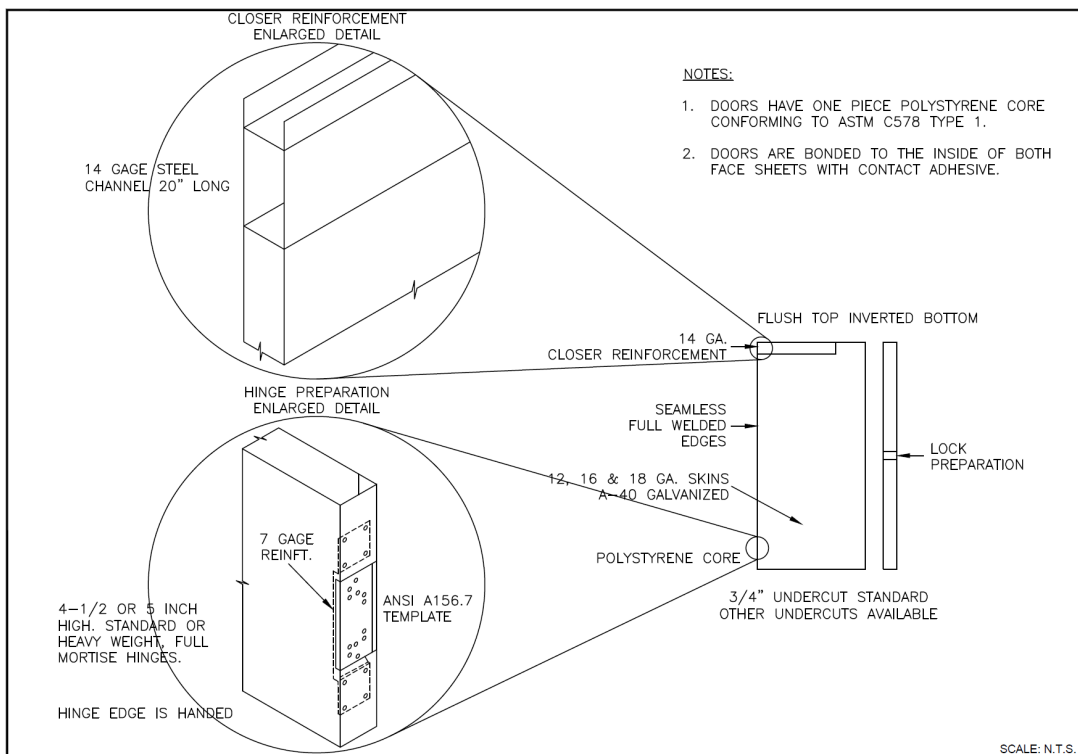

1200 Steel Stiffened Door / 1500 Lead Lined Door

Face Material	Galvannealed A40 or A60 ASTM-A-653
Face thickness	12, 14, 16 and 18 Ga.
Lead Lining	Center door lead lining (optional)
Construction	Hollow metal with vertical steel stiffeners (ribs). Space between ribs Insulated with glass wool insulation
Door thickness	1 3/4" Standard
Hardware Locations	Any specified location
Reinforcements	7 Ga. 1 1/4" x 10" joggled hinge reinforcement, drilled and tapped 12 Ga. mortise hardware tabs, drilled and tapped 14 Ga. surface hardware and trim reinforcement
Edge reinforcement	Vertical and horizontal edges reinforced with 16 Ga. (min) full length channels spot welded to the face sheets
Vertical edges	Fully welded with no visible seam (for doors up to 10' height and 4' width)
Glazing/ Louvers	Glazing stops to be set for 1/4" glass (3/8" space) unless other wise requested. Note: Glass should be cut 1/4" less than door cut out. Exposed glass opening is 1 5/16" less than cutout dimensions. Louver size is actual size of door cutout
Handing	Doors are handed
Appearance	Faces and edges free of defects, warp and buckle
Finish	Thoroughly cleaned and coated with a rust inhibiting primer meeting requirements as per ANSI/SDI A250.10
Options	UL Labeling requirements as specified

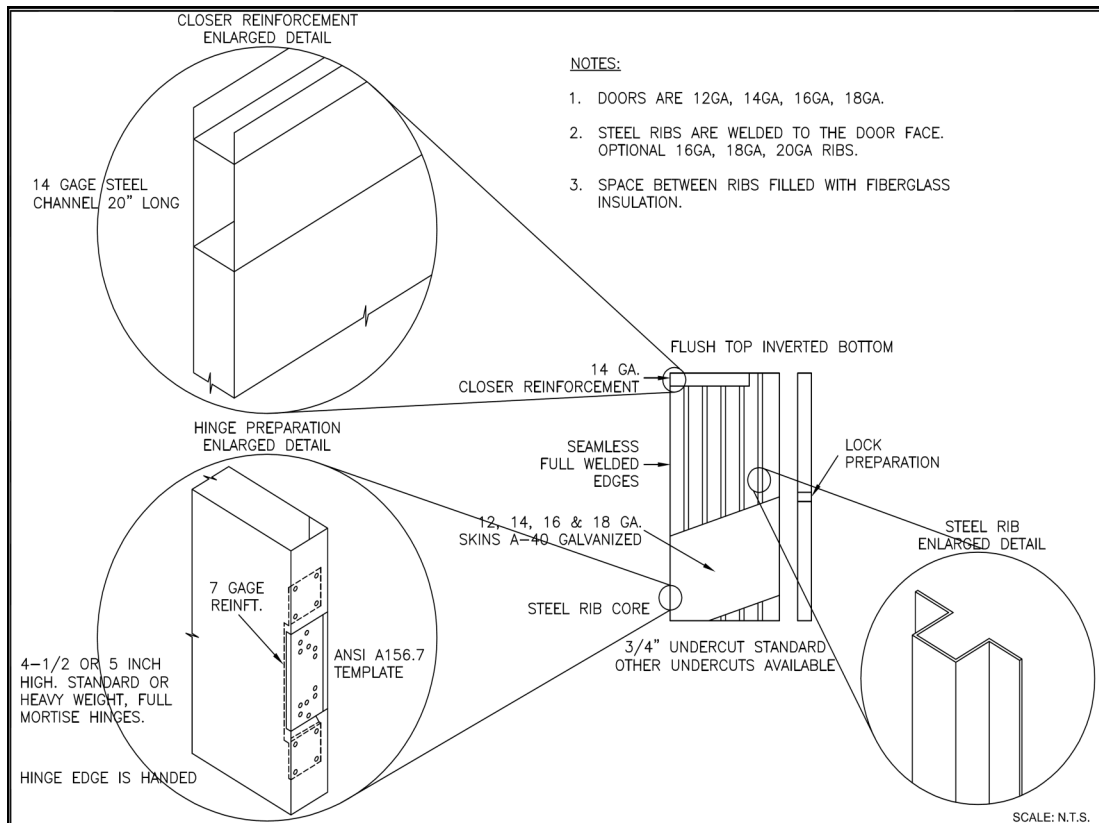

1300 Temperature Rise Door

Face Material	Galvannealed A40 or A60 ASTM-A-653
Face thickness	12, 14, 16 and 18 Ga.
Construction	Rigid mineral board core bonded to both face sheets
Door thickness	1 3/4" Standard
Hardware Location	Any specified locations
Reinforcements	7 Ga. 1 1/4" x 10" joggled hinge reinforcement, drilled and tapped 12 Ga. mortise hardware tabs, drilled and tapped 14 Ga. surface hardware and trim reinforcement
Edge reinforcement	Vertical and horizontal edges reinforced with 16 Ga. full length channels spot welded to the face sheets
Vertical edges	Fully welded with no visible seam (for doors up to 10' height and 4' width)
Glazing	Glazing stops to be set for 1/4" glass (3/8" space) unless other wise requested. Note: Glass should be cut 1/4" less than door cut out. Exposed glass opening is 1 5/16" less than cutout dimensions. Glass area up to 100 sq. inches.
Handing	Doors are handed
Appearance	Faces and edges free of defects, warp and buckle
Finish	Thoroughly cleaned and coated with a rust inhibiting primer meeting requirements as per ANSI/SDI A250.10
Temperature Options	60-180 min. Labels available for 450 degree and 250 degree temp. UL Labeling requirements as specified

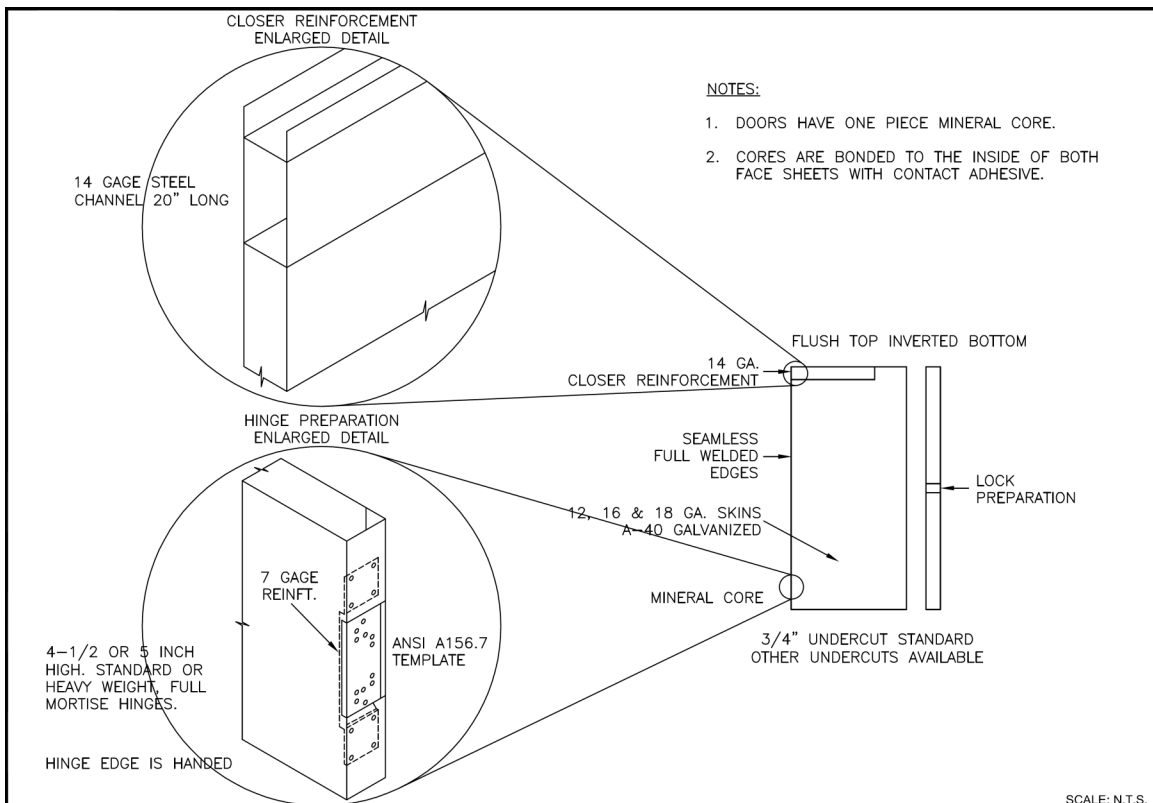

1600 Dutch Doors

Face Material	Galvannealed A40 or A60 ASTM-A-653
Face thickness	12, 14, 16 and 18 Ga.
Construction	Can be manufactured as a Polystyrene Core (1100 door) or Steel Stiffened Door (1200 door)
Door thickness	1 3/4" Standard
Hardware Locations	Any specified locations
Reinforcements	7 Ga. 1 1/4" x 10" joggled hinge reinforcement, drilled and tapped 12 Ga. mortise hardware tabs, drilled and tapped 14 Ga. surface hardware and trim reinforcement
Edge reinforcement	Both edges reinforced with 16 Ga. full length channels spot welded to the face sheets
Vertical edges	Fully welded with no visible seam (for doors up to 4' wide and 8' high)
Glazing/ Louvers	Glazing stops to be set for 1/4" glass (3/8" space) unless otherwise requested. Note: Glass should be cut 1/4" less than door cut out. Exposed glass opening is 1 5/16" less than cutout dimensions. Louver size is actual size of door cutout
Handing	Doors are handed
Appearance	Faces and edges free of defects, warp and buckle
Finish	Thoroughly cleaned and coated with a rust inhibiting primer meeting requirements as per ANSI/SDI A250.10
Options	Shelf available as specified

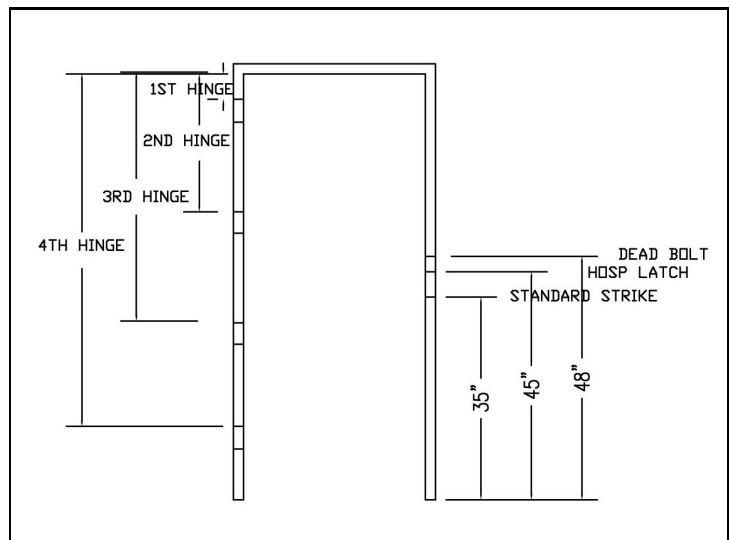
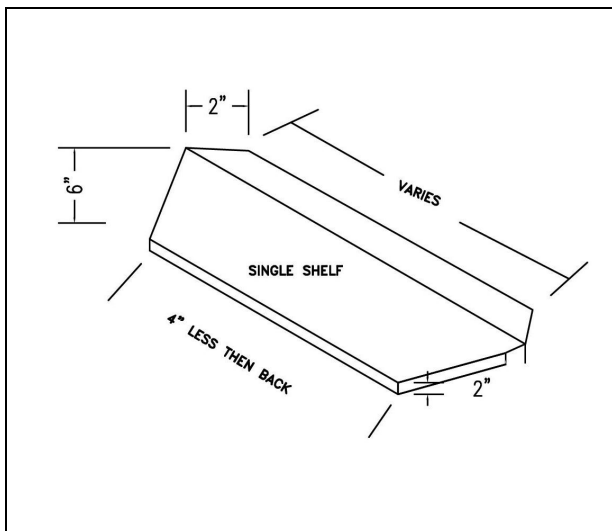

1600 Dutch Doors

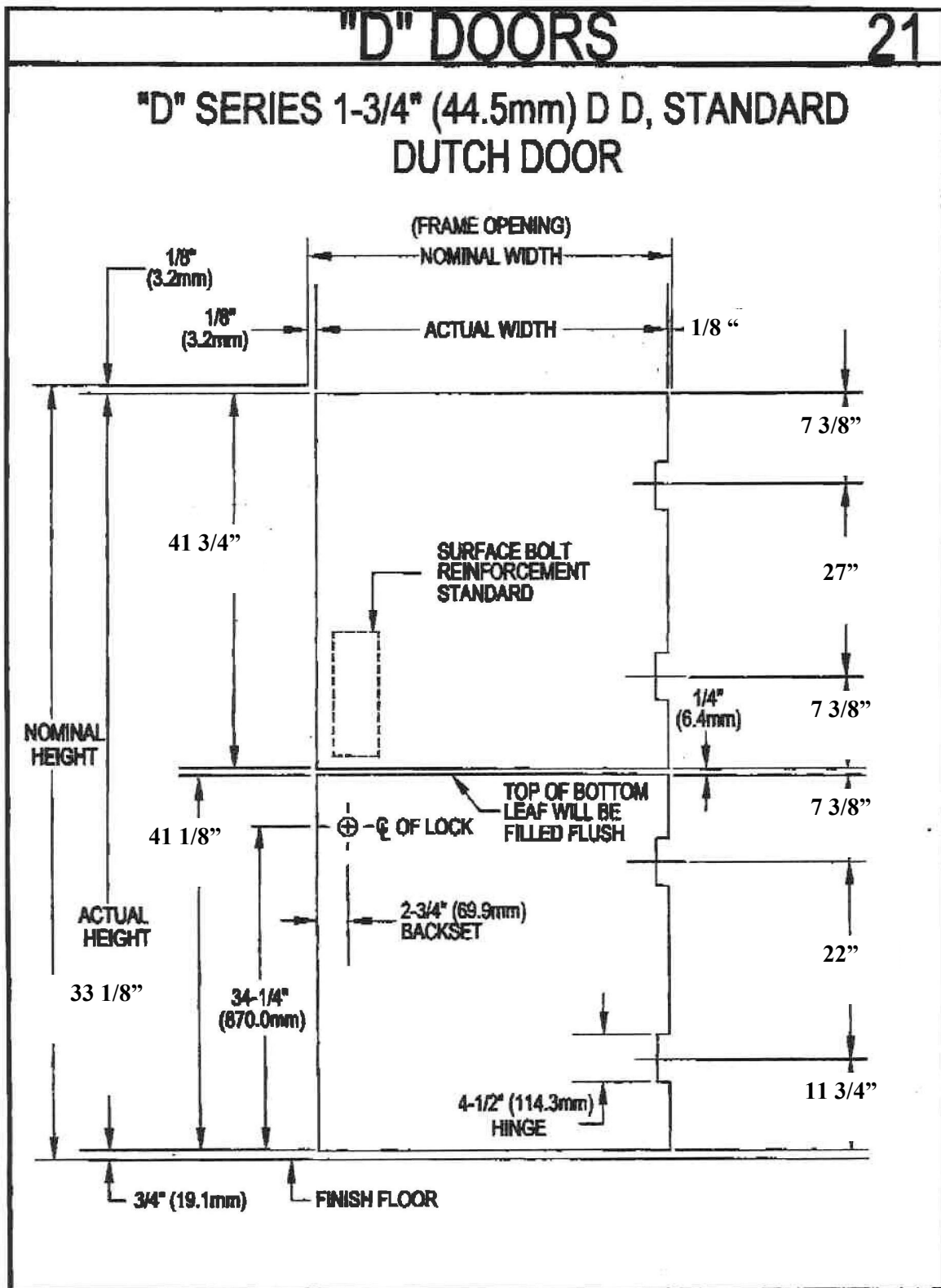

Hollow Metal Frames

A full line of standard and custom frames:

- Standard door frames, fully or face welded, optional with Hospital stops
- Window frames
- Sidelights
- Standard, window and sidelight frames can be supplied lead lined
- Knock down (KD) frames for welding
- Dry wall knock down (KD frames)
- Custom frames
- Pocket Frames
- Double Egress Frames
- Frames available in 12 GA, 14 GA and 16 GA

Manufacturing Tolerances for Frames

Frames for single door or pair of doors:

Width, measured between rabbets at the head; nominal opening width $+1/18'' - 1/32''$

Height (total length of jamb rabbet): nominal opening height $\pm 3/64''$

Frames overlapping walls to have throat dimension $1/8''$ greater than dimensioned wall thickness to accommodate irregularities in wall construction.

Standard frame anchors

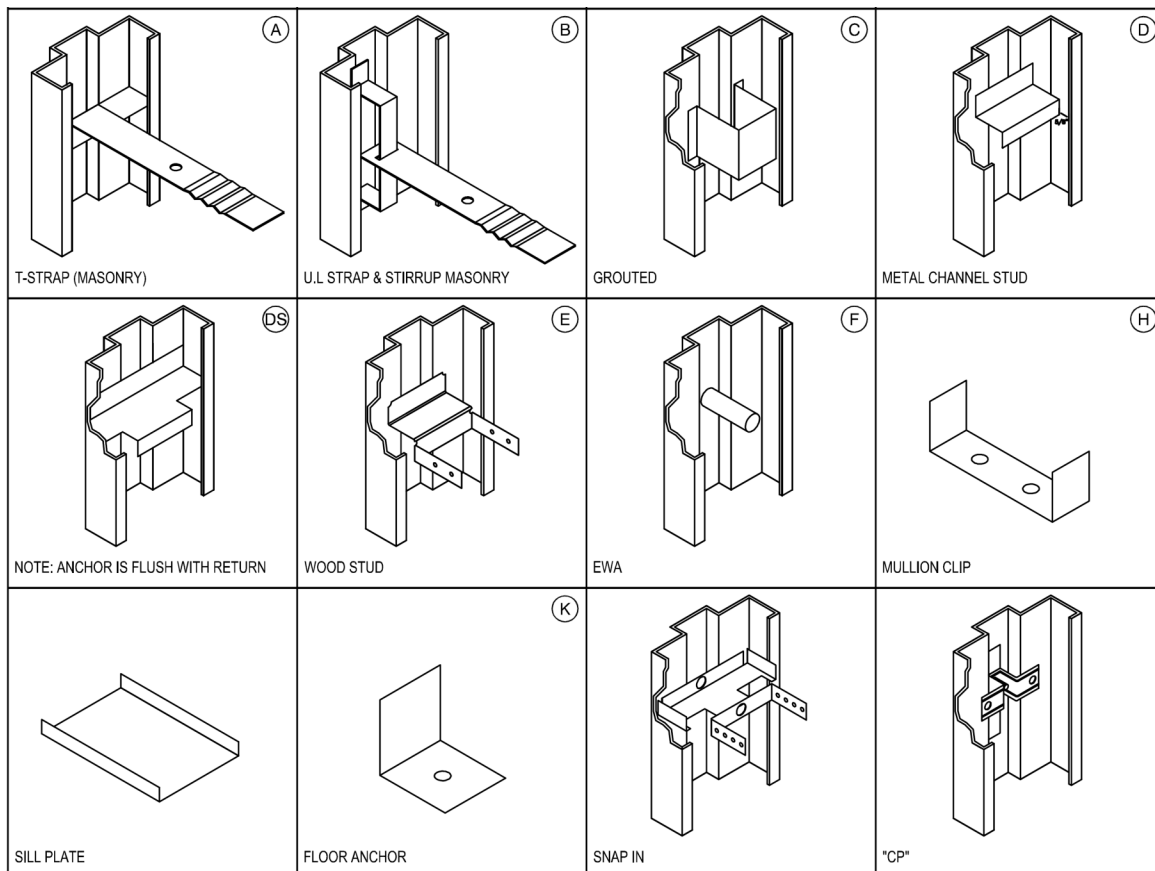

Hollow Metal Frames

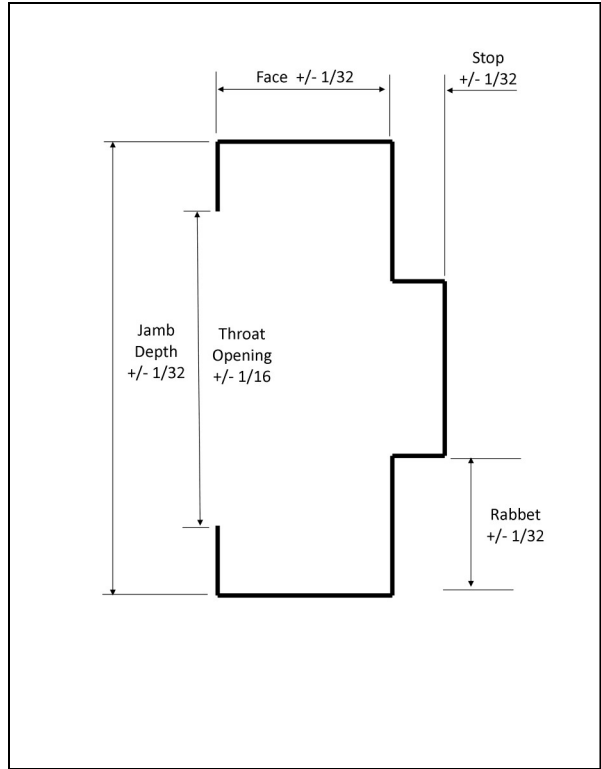

Standard frame sections

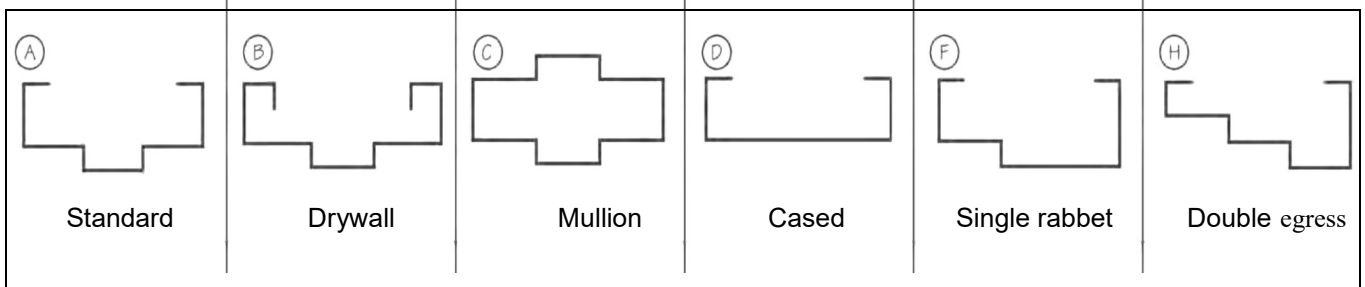

Standard frame elevations

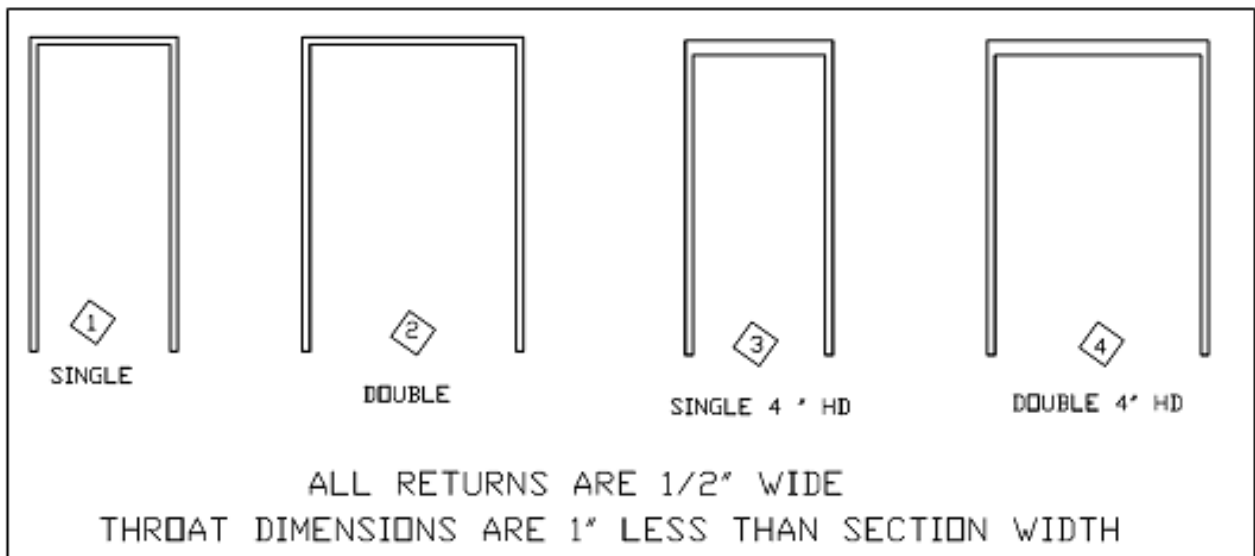

Welded Frames

Material	Galvannealed A40 ASTM-A-653
Thickness	12, 14 and 16 Ga.
Construction	Mitered and welded face and back alternatively welded face only
Appearance	Square, true and free of defects, warp and buckle
Hardware	7 Ga. 1 1/4" x 10" joggled hinge reinforcement, drilled and tapped. 12 Ga hardware reinforcements. Backwelded for additional strength. Also mortised, enforced, drilled and tapped at the factory for hardware in accordance with approved schedule and templates provided by hardware contractor. Strike jambs prepared for three rubber silencers, unless otherwise specified
Anchors	Anchors as specified. For standard frames, four 16 Ga. weld in sill anchors per jamb
Guards	Dust covers on all frames. Mortar guards on frames for masonry walls.
Spreaders	Temporary spreader bars welded to the bottom of all three sided frames. To be removed before installation
Marking	Embossed with opening numbers above the middle hinge. In the jamb for continuous hinge frames
Finish	Thoroughly cleaned and coated with a rust inhibiting primer meeting requirements as per ANSI/SDI A250.10

Typical Hardware Preparations

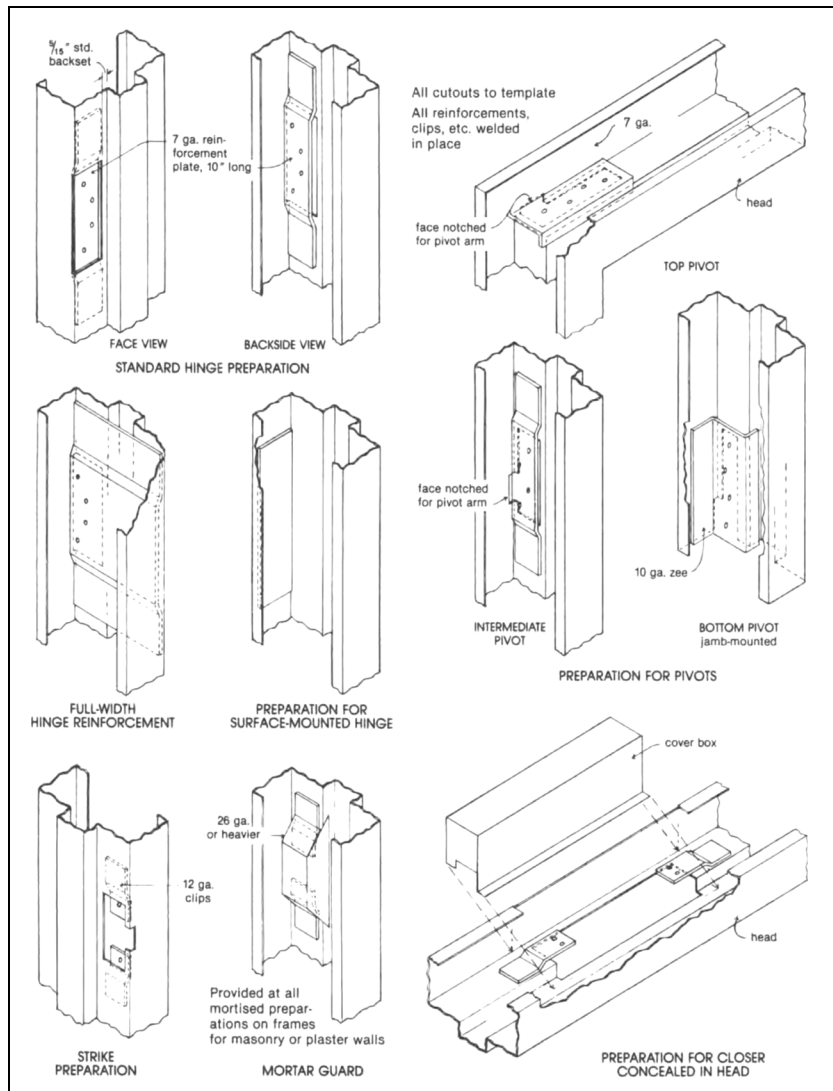

Knockdown (KD) Frames

The frames provided by Rocky Mountain Metals, Inc. are of two types. They are either made to be welded or to be installed in a pre-installed or existing drywall wall.

Material	Galvannealed A40 ASTM-A-653
Thickness	12, 14 and 16 Ga.
Construction	Mitered with self aligning tabs and slots for securely locking the corners
Appearance	Free of defects, warp and buckle
Hardware	7 Ga. 1 1/4" x 10" joggled hinge reinforcement, drilled and tapped. Back welded for additional strength. Also mortised, enforced, drilled and tapped at the factory for hardware in accordance with approved schedule and templates provided by Hardware Contractor. Strike jambs prepared for three rubber silencers, unless otherwise specified
Anchors	Anchors as specified. For standard frames, four 16 Ga. weld in sill anchors per jamb
Guards	Dust covers on all frames. Mortar guards on frames for masonry walls. KD frames for drywall walls supplied with one compression anchor per jamb
Marking	Embossed with opening numbers above the middle hinge. In the head for continuous hinge frames. Temporary marking of heads and jamb to ensure correct pairing
Finish	Thoroughly cleaned and coated with a rust inhibiting primer meeting requirements as per ANSI/SDI A250.10

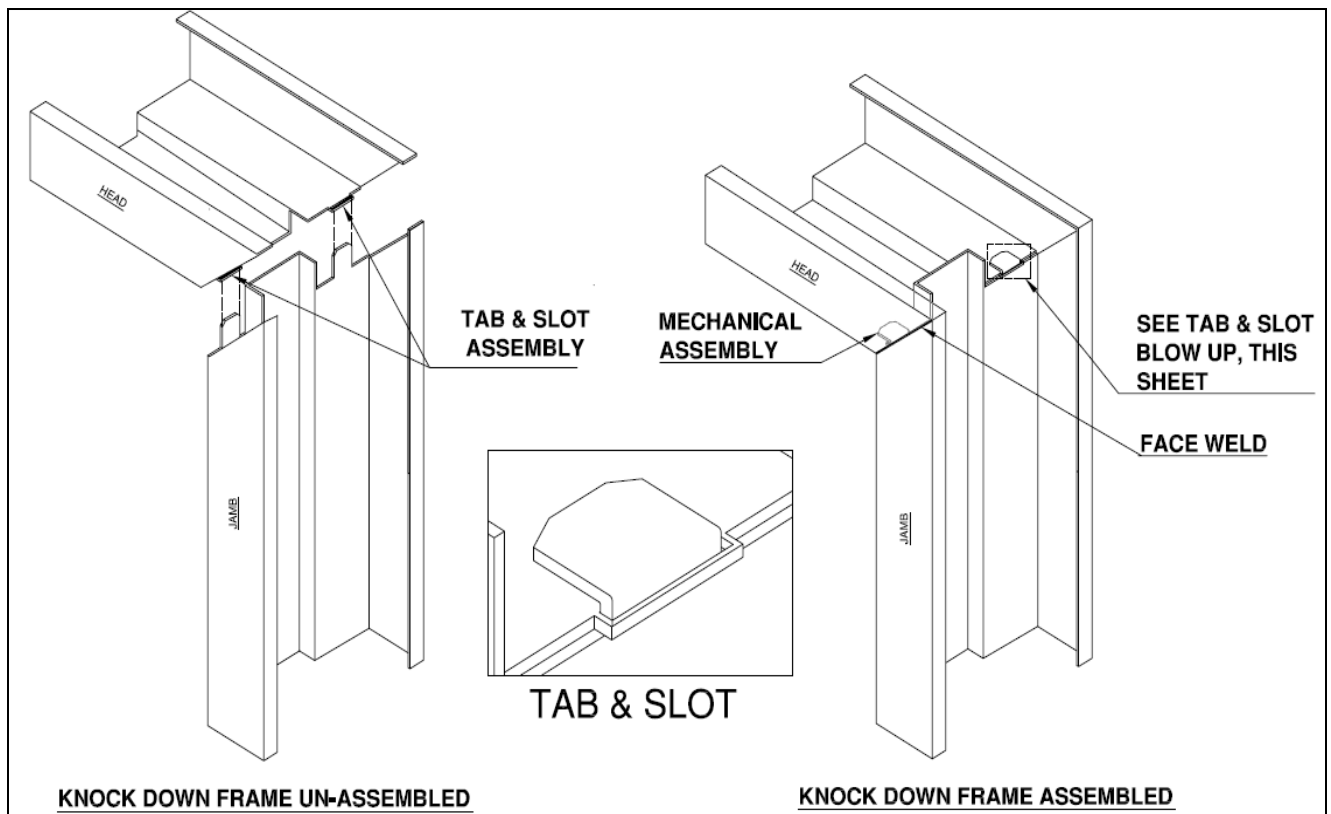

Pocket Frames

Material	Galvannealed A40 ASTM-A-653
Thickness	12, 14 and 16 Ga.
Construction	Mitered and welded face and back alternatively welded face only
Appearance	Square, true and free of defects, warp and buckle
Hardware	Optional prep to accept hardware as specified
Anchors	Anchors to meet any wall construction
Strike	Any specified location
Jamb Width	6" Standard
Guards	Dust covers on all frames. Mortar guards on frames for masonry walls.
Spreaders	Temporary spreader bars welded to the bottom of all three sided frames. To be removed before installation
Marking	Embossed with opening numbers above the middle hinge. In the jamb for continuous hinge frames
Finish	Thoroughly cleaned and coated with a rust inhibiting primer meeting requirements as per ANSI/SDI A250.10
NOTE	Sliding and tracking not provided

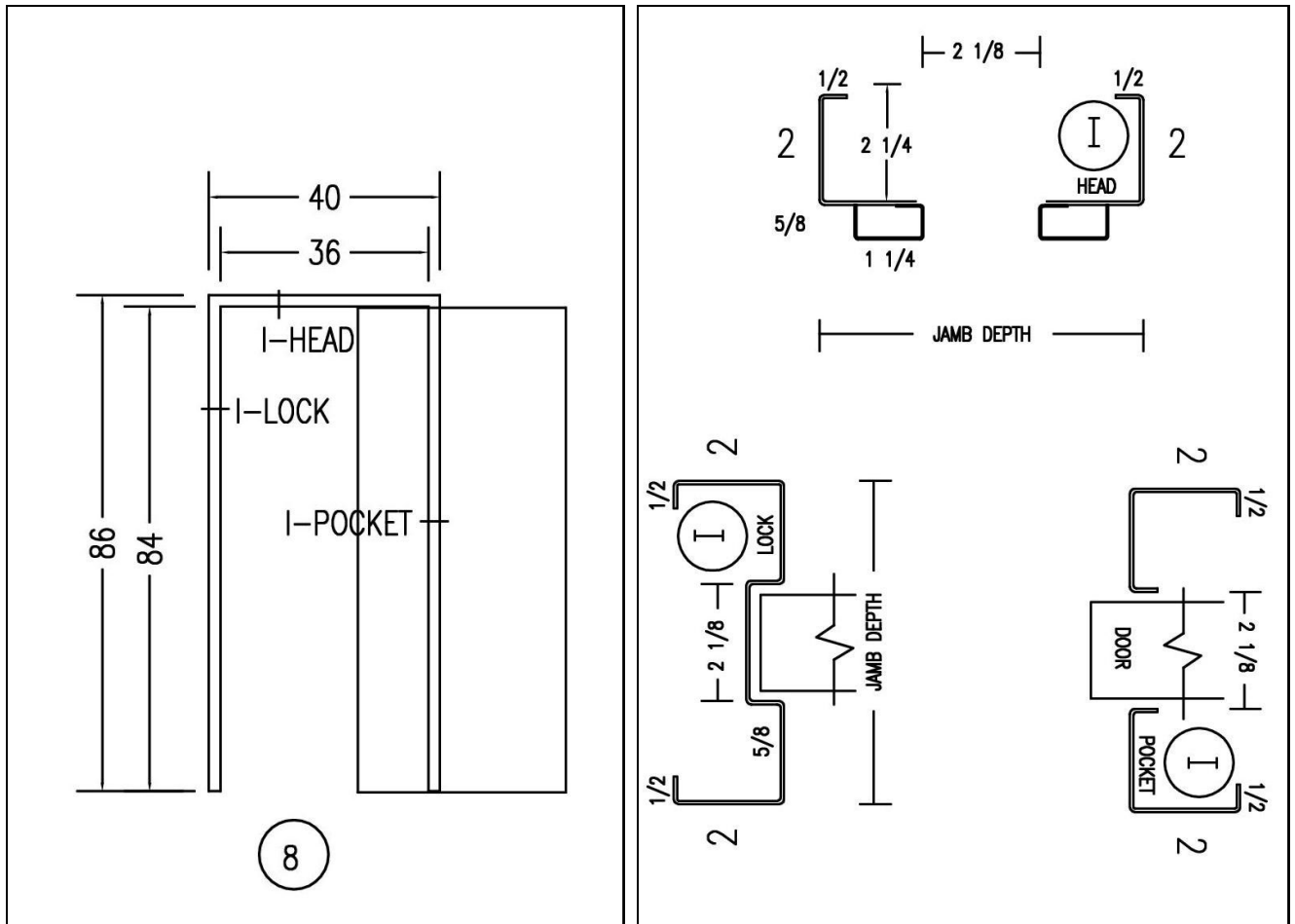

Custom Frames

Rocky Mountain Metals, Inc. has been in business since 1988 and our entire focus is on hollow metal manufacturing. Our plant is fully equipped with modern equipment to cater to your Standard and Custom Hollow Metal needs.

We have the ability to produce complex custom configurations to meet a wide variety of individual needs. Our strong focus is on quick quoting, quality, cost efficiency and quick shipping. In addition to your specific needs and specifications, our products are built by elements according to the NAAMM Standard HMMA 860, 861 and 862. We are a member of NAAMM and we manufacture products in accordance with the Steel Door Institute standards.

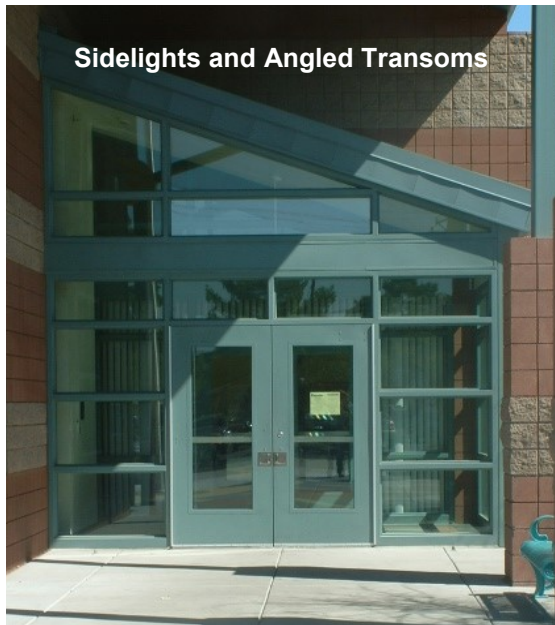

Custom Frames

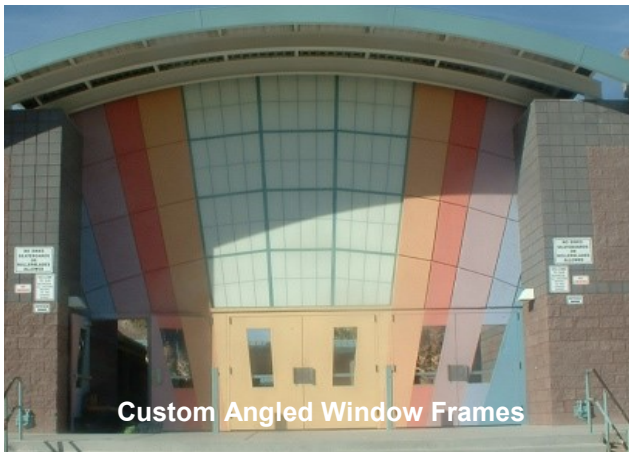
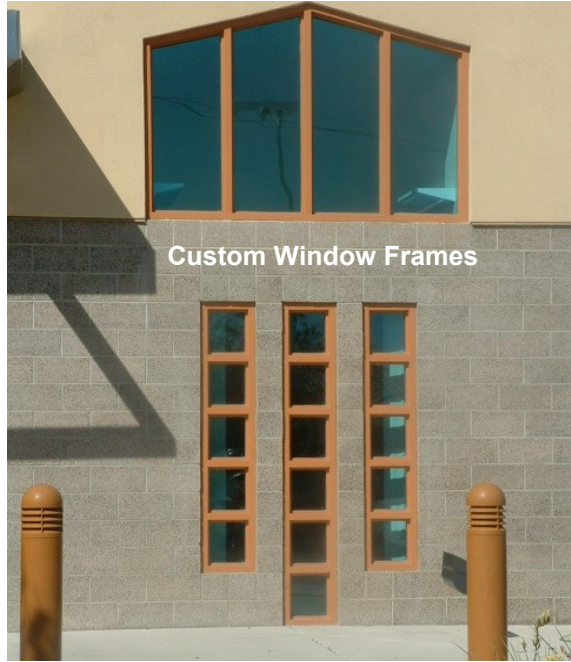
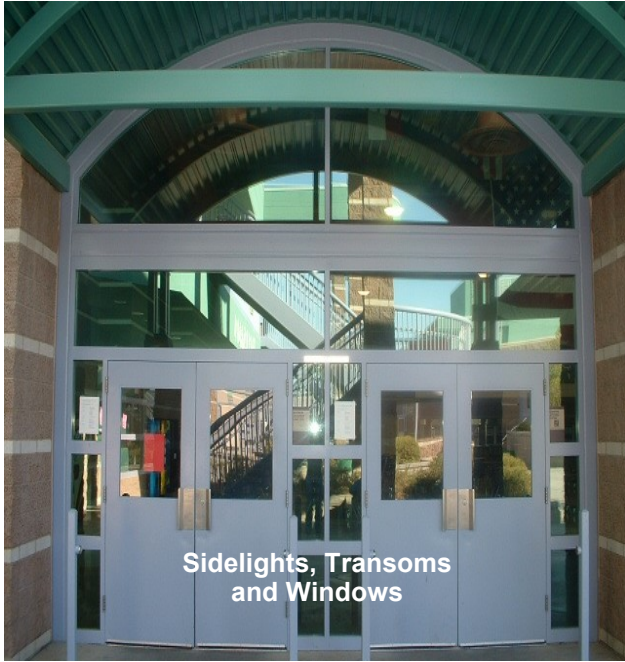

Tornado Resistant Openings



Rocky Mountain Metals, Inc. introduces Openings Solutions classified to FEMA P-361 (2015) and certified to ICC 500 (2014). These openings are tested as complete assemblies including doors, frames and hardware as required by the International Building Code for use in tornado shelters in Group E occupancies. This includes among other applications new construction at K-12 schools and extends to critical emergency operation facilities.

The offerings consists of openings of up to 8 ft. in width and 9 ft. in height for double doors and 4 ft. in width and 9 ft. in height for single doors and is also extended to shutters (openings with four sided frames).

Single Doors and Shutters

Min dimensions	width	2 ft 6 inches
	height	4 ft
Max dimensions	width	4 ft
	height	9 ft
In and out swing		

Double doors

Min dimensions	width	6 ft
	height	6 ft 8 inches
Max dimensions	width	8 ft
	height	9 ft
Out swing only		

1400 FEMA Frame and Shutter Frame Details for Tornado Resistant Openings

Material	Galvannealed A40 ASTM-A-653
Thickness	14 Ga. Galvannealed
Dimensions	2" jambs and 2" or 4" heads as specified
Construction	Mitered and welded face and back
Appearance	Square, true and free of defects, warp and buckle
Reinforcements	4 pcs 7 Ga. 1 1/4" x 10" joggled hinge reinforcement, drilled and tapped. Back welded for additional strength Strike and bolt preps 12 Ga. x 12" long, spot and MIG welded Strike jambs prepared for three rubber silencers, unless Otherwise specified
Hardware Locations	Any specified locations
Guards	Dust covers on all frames. Mortar guards on frames for masonry walls
Wall Anchors	Below 7' in Height - 4 anchors 7' and above in Height - 5 anchors
Head Anchors	5' and above in Width - 2 anchors
Bolts	As per specified by RMMI
Spreaders	Temporary spreader bars welded to the bottom of all three sided frames. To be removed before installation
Marking	Embossed with opening numbers above the middle hinge. In the jamb for continuous hinge frames
Finish	Thoroughly cleaned and coated with a rust inhibiting primer meeting requirements as per ANSI/SDI A250 10
Options	UL labeling requirements as specified
Shutter Frame Sizes	Min: 2' 6" x 4' Max: 4' x 9'
Door Frame Sizes	Min: 2' 6" x 4' Max: 8' x 9'

Shutter Frames are manufactured as four sided frames

1400 FEMA Frames for Tornado Resistant Openings

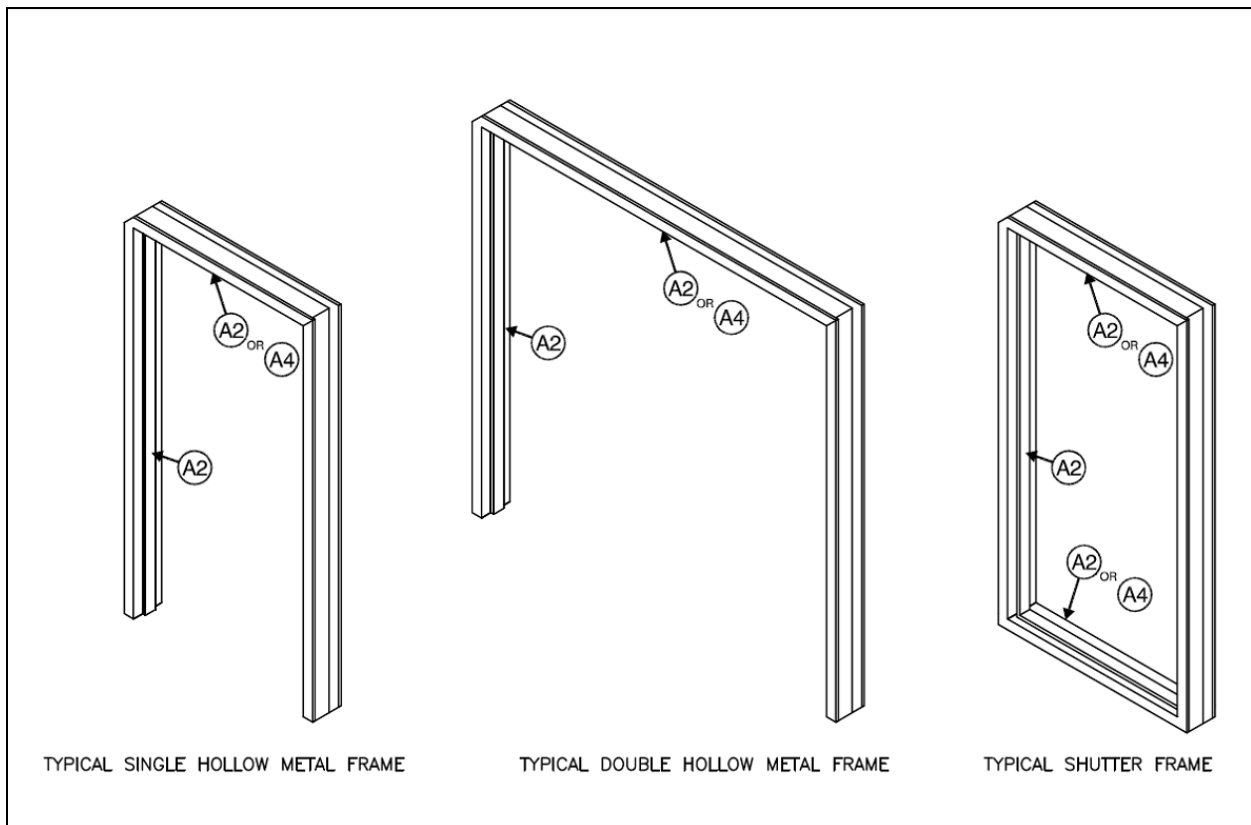
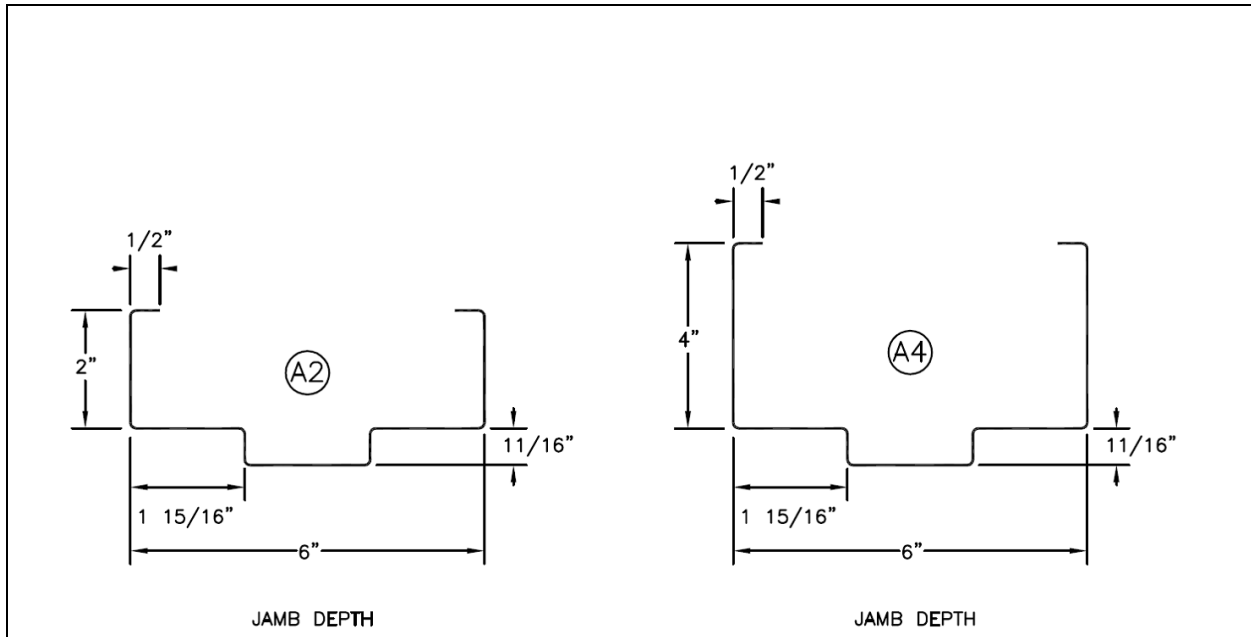

1400 FEMA Door/Shutter for Tornado Resistant Openings

Face Material	Galvannealed A40 or ASTM-A-653
Face thickness	14 Ga.
Construction	Hollow metal with 18 Ga. vertical steel stiffeners (ribs). Space insulated with glass wool insulation between ribs. Flush construction
Door thickness	1 3/4" Standard
Hardware Locations	Per Project Requirements
Reinforcements	7 Ga. 1 1/4" x 10" joggled hinge reinforcement, drilled and tapped 12 Ga. mortise hardware tabs, drilled and tapped 12 Ga. surface hardware and trim reinforcement
Edge reinforcement	Horizontal and vertical edges reinforced with 12 Ga. (min) full length channels spot welded to the face sheets
Vertical edges	Fully welded with no visible seam
Handing	Doors are handed
Appearance	Faces and edges free of defects, warp and buckle
Finish	Thoroughly cleaned and coated with a rust inhibiting primer meeting requirements as per ANSI/SDI A250.10
Options	UL Labeling requirements as specified

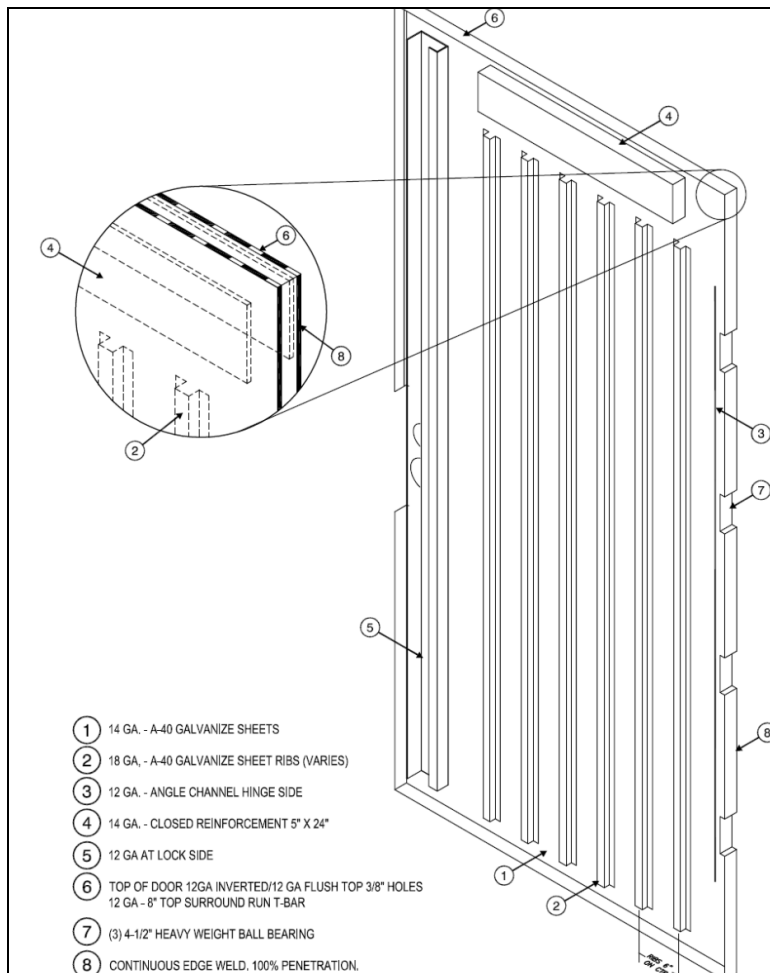

1701 Hollow Metal Door with Polystyrene Core Bullet Resistant UL 752 Level 1

Face Material	Galvannealed A40 or A60 ASTM-A-653
Face thickness	12 Ga. (0.100" min thickness) CS Type B
Construction	Rigid polystyrene core bonded to both face sheets
Door thickness	1 3/4" Standard
Hardware Locations	Any specified locations. Door hardware Certified and Listed for UL752 Level 1 application
Reinforcements	7 Ga. 1 1/4" x 10" joggled hinge reinforcement, drilled and tapped 12 Ga. mortise hardware tabs, drilled and tapped 14 Ga. surface hardware and trim reinforcement, drilled and tapped
Edge reinforcement	Both edges reinforced with 16 Ga. full length channels spot welded to the face sheets
Vertical edges	Fully welded with no visible seam (for doors up to 4' wide and 8' height)
Glazing	Glazing and Glazing Frame shall be listed for UL 752, Level 1 (Size per listing, minimum 12 x 12 in). Note: Glass should be cut 1/4" less than door cut out. Exposed glass opening is 1 5/16" less than cutout dimensions.
Handing	Doors are handed
Appearance	Faces and edges free of defects, warp and buckle
Finish	Thoroughly cleaned and coated with a rust inhibiting primer meeting requirements as per ANSI/SDI A250.10

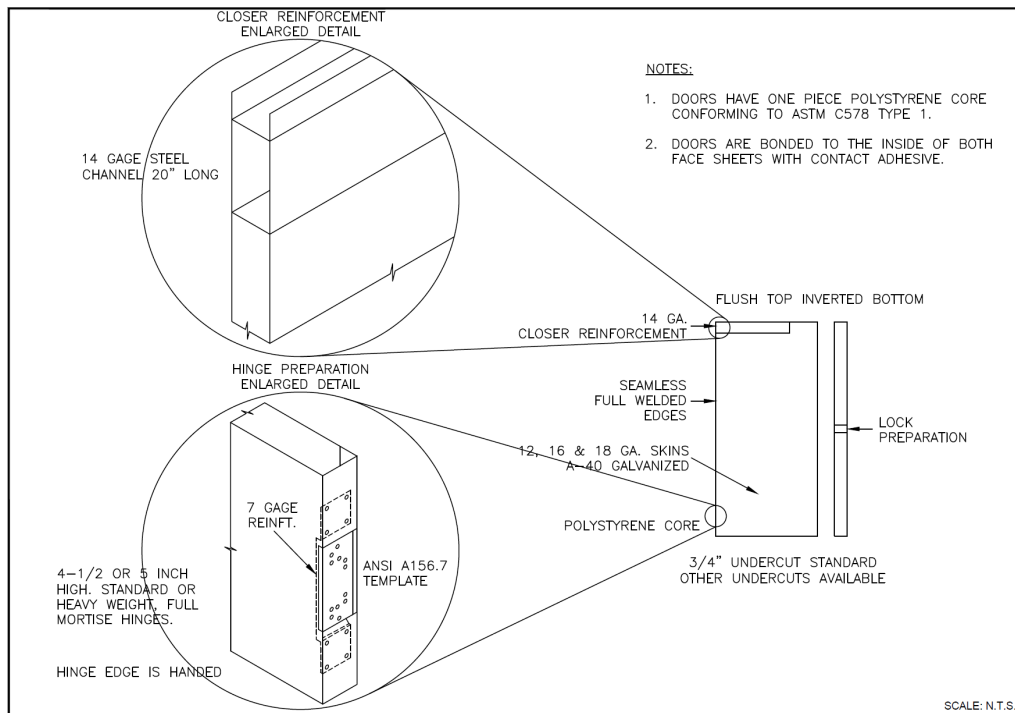

1801 Steel Stiffened Door / Bullet Resistant UL 752 Level 1

Face Material	Galvannealed A40 or A60 ASTM-A-653
Face thickness	12 Ga. (0.100" min thickness) CS Type B
Construction	Hollow metal with vertical steel stiffeners (ribs). Space between ribs Insulated with glass wool insulation
Door thickness	1 3/4" Standard
Hardware Locations	Any specified location. Door hardware Certified and Listed UL 752 Level 1 application
Reinforcements	7 Ga. 1 1/4" x 10" joggled hinge reinforcement, drilled and tapped 12 Ga. mortise hardware tabs, drilled and tapped 14 Ga. surface hardware and trim reinforcement, drilled and tapped
Steel Stiffeners	6" from edge of door, 6" on center 18 Ga.
Edge reinforcement	Vertical and horizontal edges reinforced with 16 Ga. (min) full length channels spot welded to the face sheets
Vertical edges	Fully welded with no visible seam (for doors up to 10' height and 4' width)
Glazing	Glazing and Glazing Frame shall be listed for UL 752, Level 1. (Size per listing, minimum 12 X12 in.) Glass should be cut 1/4" less than door cut out. Exposed glass opening is 1 5/16" less than cutout dimensions.
Handing	Doors are handed
Appearance	Faces and edges free of defects, warp and buckle
Finish	Thoroughly cleaned and coated with a rust inhibiting primer meeting requirements as per ANSI/SDI A250.10
Options	UL Labeling requirements as specified

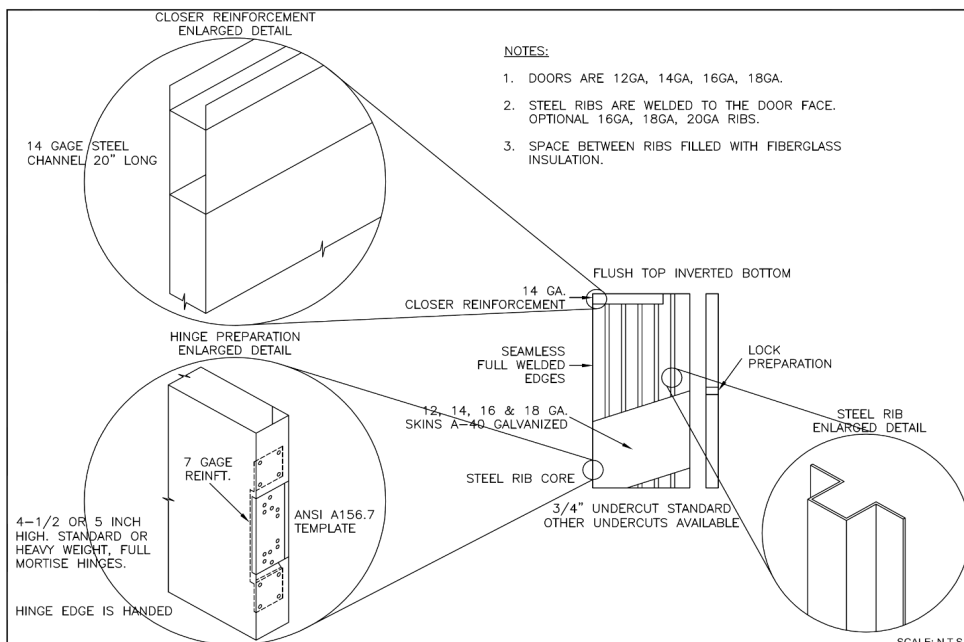

Welded Frames 1701 and 1801 Bullet Resistant Doors UL 752 Level 1

Material	Galvannealed A40 ASTM-A-653
Thickness	12 Ga. (0.100" min thickness) CS Type B
Construction	Mitered and welded face and back
Appearance	Square, true and free of defects, warp and buckle
Hardware	7 Ga. 1 1/4" x 10" joggled hinge reinforcement, drilled and tapped. 12 Ga hardware reinforcements. Backwelded for additional strength. Also mortised, enforced, drilled and tapped at the factory for hardware in accordance with approved schedule and templates provided by hardware contractor. Strike jambs prepared for three rubber silencers, unless otherwise specified
Anchors	Anchors as specified. For standard frames, four 16 Ga. weld in sill anchors per jamb
Guards	Dust covers on all frames. Mortar guards on frames for masonry walls.
Spreaders	Temporary spreader bars welded to the bottom of all three sided frames. To be removed before installation
Marking hinge	Embossed with opening numbers above the middle hinge. In the jamb for continuous
Finish	Frames Frames and Doors labeled for UL 752 Level 1 or UL 752 Level 3 Thoroughly cleaned and coated with a rust inhibiting primer meeting requirements As per ANSI/SDI A250.10

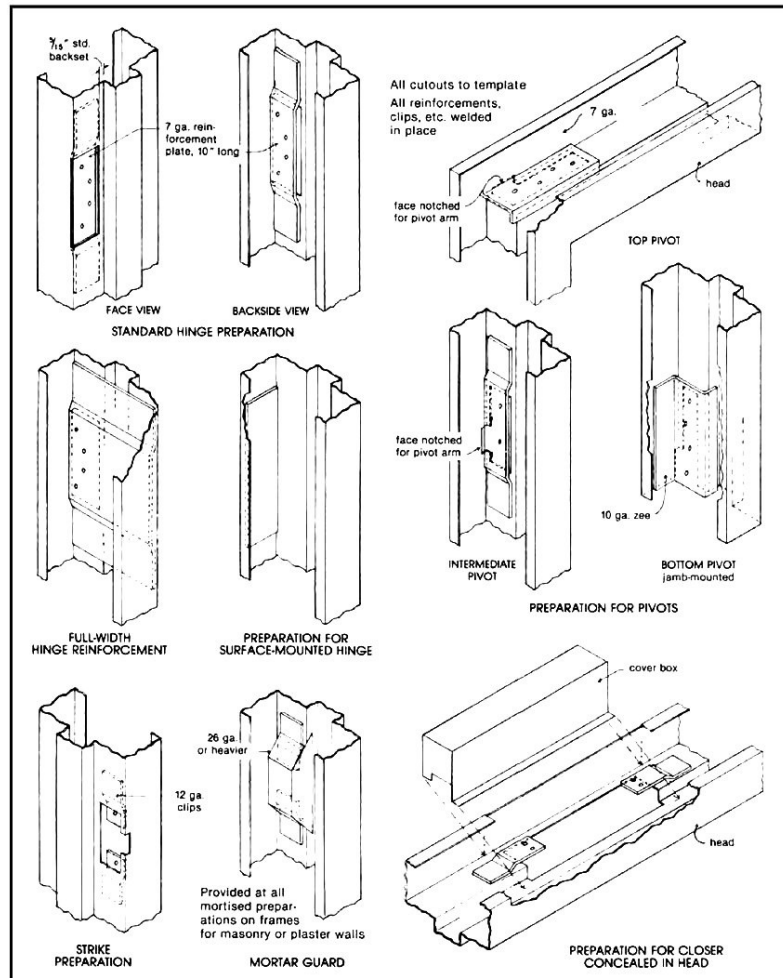

1703 Hollow Metal Door with Polystyrene Core Bullet Resistant, UL 752 Level 3

Face Material	Galvannealed A40 or A60 ASTM-A-653
Face thickness	12 Ga. (0.100" min thickness) CS Type B
Construction	Rigid polystyrene core bonded to both face sheets
Door thickness	1 3/4" Standard
Hardware Locations	Any specified locations. Door hardware Certified and Listed For UL 752 Level 3 application
Reinforcements	7 Ga. 1 1/4" x 10" joggled hinge reinforcement, drilled and tapped 12 Ga. mortise hardware tabs, drilled and tapped 14 Ga. surface hardware and trim reinforcement, drilled and tapped
Edge reinforcement	Both edges reinforced with 16 Ga. full length channels spot welded to the face sheets
Vertical edges	Fully welded with no visible seam (for doors up to 4' wide and 8' height
Glazing	Glazing and Glazing Frame shall be listed for UL 752, Level 3 (Size per listing, minimum 12 x 12 in). Note: Glass should be cut 1/4" less than door cut out. Exposed glass opening is 1 5/16" less than cutout dimensions.
Handing	Doors are handed
Appearance	Faces and edges free of defects, warp and buckle
Finish	Thoroughly cleaned and coated with a rust inhibiting primer meeting requirements as per ANSI/SDI A250.10

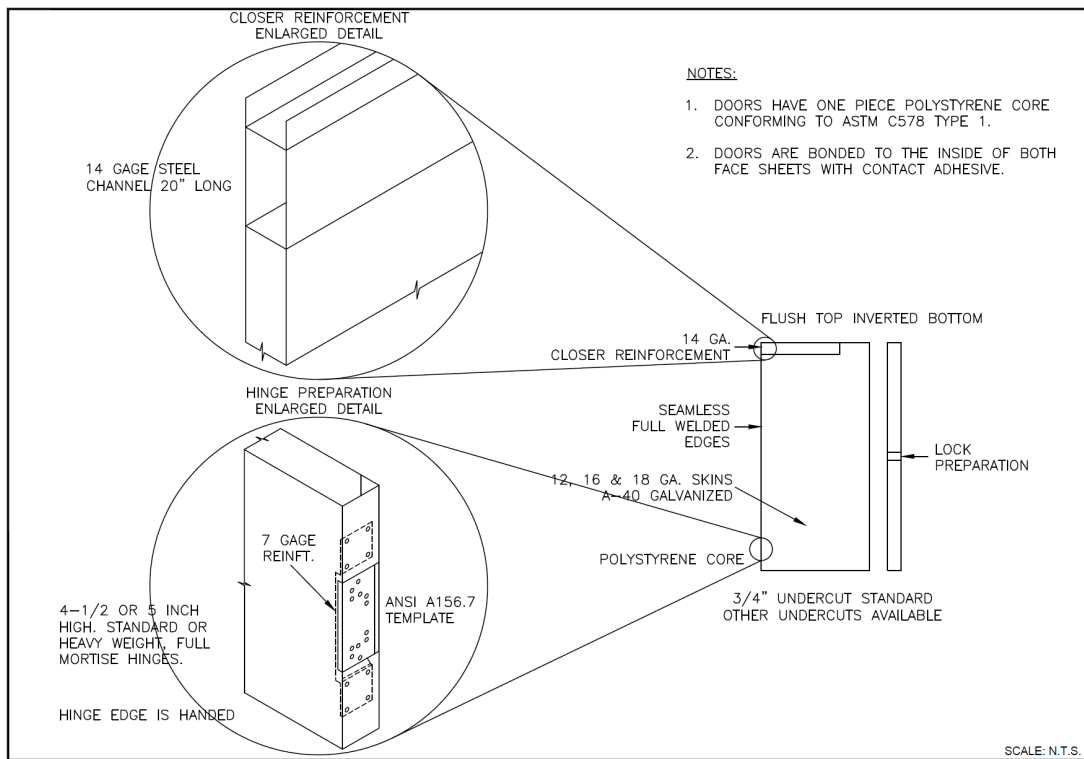

1803 Steel Stiffened Door / Bullet Resistant UL 752 Level 3

Face Material	Galvannealed A40 or A60 ASTM-A-653
Face thickness	12 Ga. (0.100" min thickness) CS Type B
Construction	Hollow metal with vertical steel stiffeners (ribs). Space between ribs Insulated with glass wool insulation
Door thickness	1 3/4" Standard
Hardware Locations	Any specified location. Door hardware Certified and Listed for UL 752 Level 3 application
Reinforcements	7 Ga. 1 1/4" x 10" joggled hinge reinforcement, drilled and tapped 12 Ga. mortise hardware tabs, drilled and tapped 14 Ga. surface hardware and trim reinforcement, drilled and tapped
Steel Stiffeners	6" from edge of door, 6 " on center 18 Ga.
Edge reinforcement	Vertical and horizontal edges reinforced with 16 Ga. (min) full length channels spot welded to the face sheets
Vertical edges	Fully welded with no visible seam (for doors up to 10' height and 4' width)
Glazing	Glazing and Glazing Frame shall be listed for UL 752 Level 3 (Size per listing, minimum 12 x 12 in) Note: Glass should be cut 1/4" less than door cut out. Exposed glass opening is 1 5/16" less than cutout dimensions.
Handing	Doors are handed
Appearance	Faces and edges free of defects, warp and buckle
Finish	Thoroughly cleaned and coated with a rust inhibiting primer meeting requirements as per ANSI/SDI A250.10

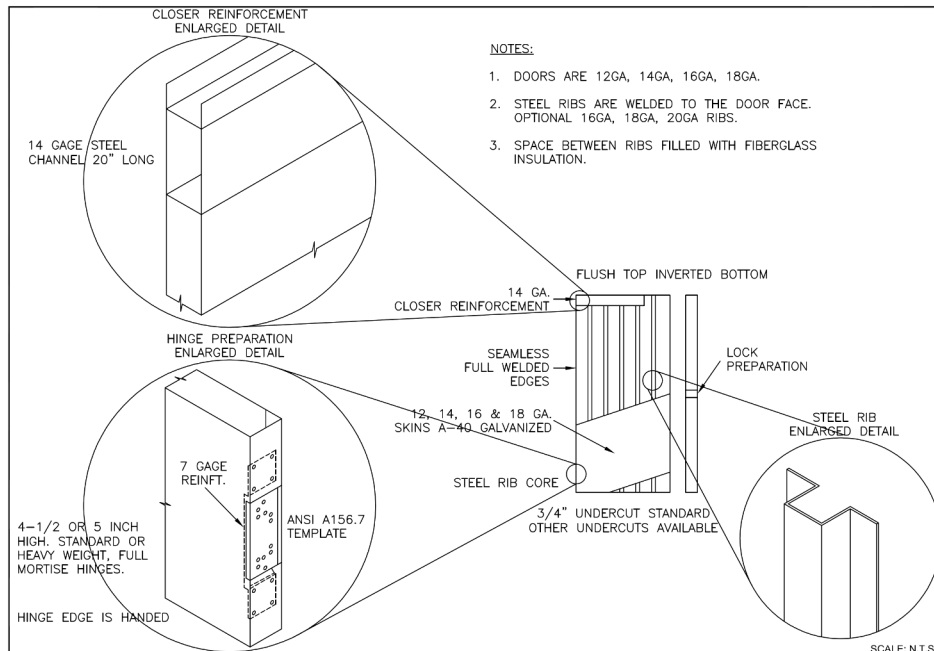

Welded Frames 1703 and 1803 Bullet Resistant Doors

Material	Galvannealed A40 ASTM-A-653
Thickness	12 Ga. Frames labeled for UL 752 Level 3 shall have 16 Ga steel reinforcement spot welded into frames. (.060 min thickness)
Construction	Mitered and welded face and back alternatively welded face only
Appearance	Square, true and free of defects, warp and buckle
Hardware	7 Ga. 1 1/4" x 10" joggled hinge reinforcement, drilled and tapped. 12 Ga hardware reinforcements. Backwelded for additional strength. Also mortised, enforced, drilled and tapped at the factory for hardware in accordance with approved schedule and templates provided by hardware contractor. Strike jambs prepared for three rubber silencers, unless otherwise specified
Anchors	Anchors as specified. For standard frames, four 16 Ga. weld in sill anchors per jamb
Guards	Dust covers on all frames. Mortar guards on frames for masonry walls.
Spreaders	Temporary spreader bars welded to the bottom of all three sided frames. To be removed before installation
Marking	Embossed with opening numbers above the middle hinge. In the jamb for continuous hinge
Finish	Frames and Doors labeled for UL 752 Level 1 or UL 752 Level 3 Thoroughly cleaned and coated with a rust inhibiting primer meeting requirements As per ANSI/SDI A250.10

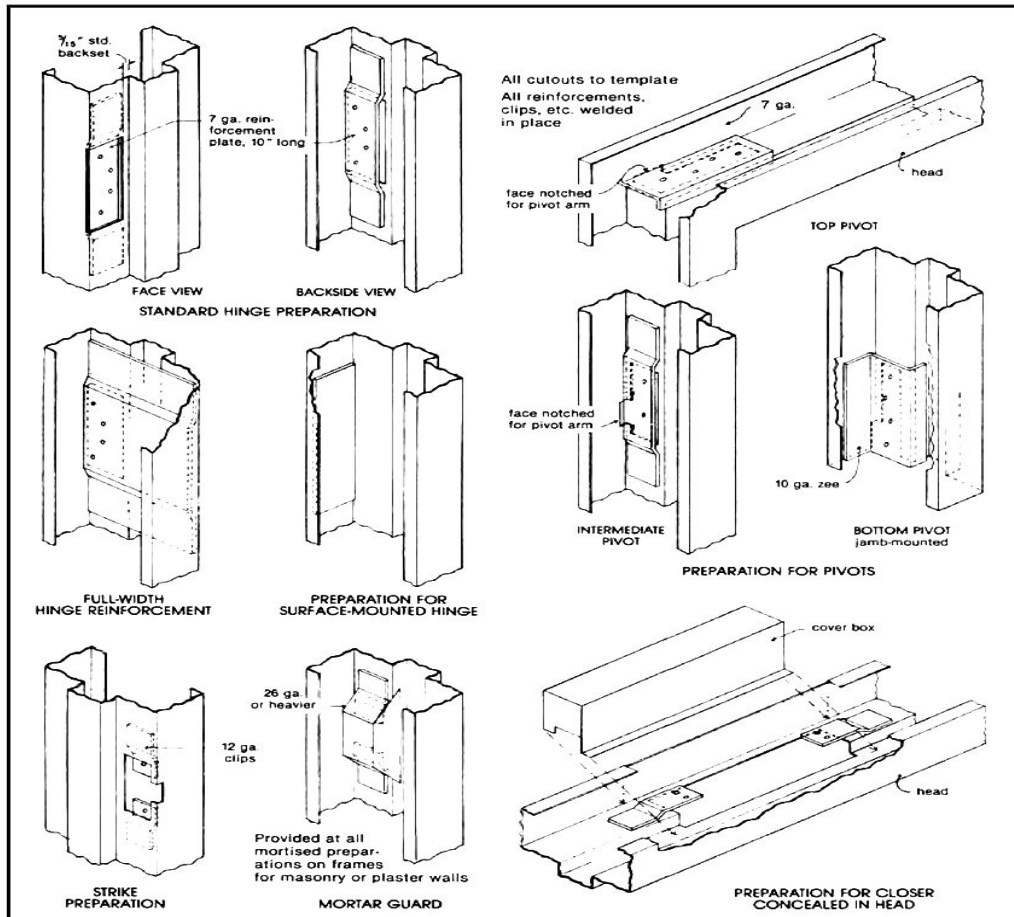

MODEL 1701/1703 AND 1801/1803 BALLISTICS ANCHORS

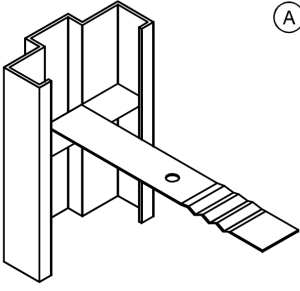
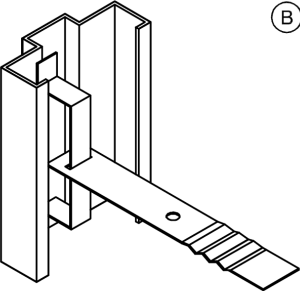
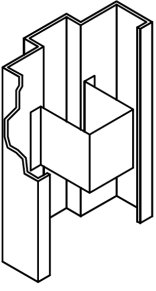
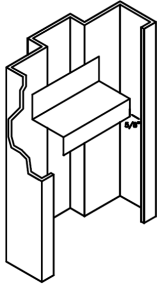
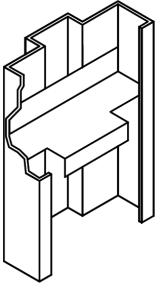
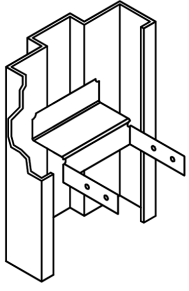
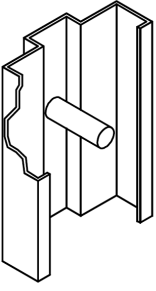
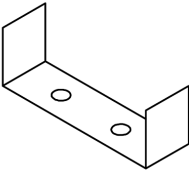
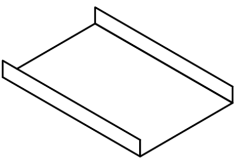
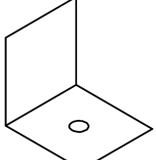
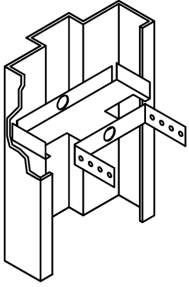
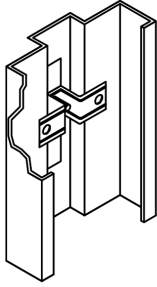
 <p>(A) T-STRAP (MASONRY)</p>	 <p>(B) U.L. STRAP & STIRRUP MASONRY</p>	 <p>(C) GROUDED</p>	 <p>(D) METAL CHANNEL STUD</p>
 <p>(DS) NOTE: ANCHOR IS FLUSH WITH RETURN</p>	 <p>(E) WOOD STUD</p>	 <p>(F) EWA</p>	 <p>(H) MULLION CLIP</p>
 <p>SILL PLATE</p>	 <p>(K) FLOOR ANCHOR</p>	 <p>SNAP IN</p>	 <p>"CP"</p>

Leadership in Energy and Environmental Design (LEED)

LEED – The Leadership in Energy and Environmental Design Green Building System is the nationally accepted rating system for the design, construction and operation of sustainable and energy efficient buildings. The LEED Certification promotes a complete building system and focuses on five key areas of human and environmental health:

- Sustainable site development
- Water savings
- Energy efficiency
- Materials selection
- Indoor environmental quality

All products from Rocky Mountain Metals, Inc. qualify for LEED Credits as per below:

Full credit for recycled content MR.4.1 and 4.2 as Doors as well as Frames from Rocky Mountain Metals, Inc. contain more than 25% recycled material as per the LEED Definitions (100% of Post Consumer and 50% of Pre Consumer Recycled Content).

For further information about the requirements see below:

Credit	Requirement
Recycled Content MR 4.1	Use material with recycled content such that the sum of the post-consumer recycled content plus 50% of the pre-consumer content constitutes at least 10% of the total values of the material in the project
Recycled Content MR 4.2	Use material with recycled content such that the sum of the post-consumer recycled content plus 50% of the pre-consumer recycled content constitutes an additional 10% beyond MR 4.1 Credit (total 20%) based on cost of the total values of the material in the project
Regional Materials MR 5.1	Use a minimum of 20% of the combined value of construction and Division 12 materials and products that are manufactured (final assembly of components) within a radius of 500 miles.

Definitions:

Post-consumer recycled content – Waste material generated by households or by commercial, industrial or institutional facilities in their role as end-users of the product, which can no longer be used for its intended purposes.

Pre-consumer (post-industrial) recycled content – scraps left over during industrial or manufacturing processes, which are subsequently reused.

Contact Information

You can reach us at Rocky Mountain Metals, Inc.

Phone: 575.445.2756 **Fax:** 575.303.7069

Email

info@rockymountainmetals.com
sales@rockymountainmetals.com

Production / GM

Greg Ornelas gornelas@rockymountainmetals.com

Sales and Estimating

Jae Leavitt jleavitt@rockymountainmetals.com
Ryan Sanchez rsanchez@rockymountainmetals.com

Delivery and Billing

Jonas Thelin jthelin@rockymountainmetals.com

Engineering

Brittan Buchannan bbuchannan@rockymountainmetals.com
Robert Johnson rjohnson@rockymountainmetals.com

You can also find us online at

RockyMountainMetals.com



Our Address is: 140 Coal St, Raton, NM 87740

CERTIFICATIONS



[Read more at
http://industries.ul.com/building-materials](http://industries.ul.com/building-materials)

BUY AMERICAN ACT

All Rocky Mountain Metals, Inc. standard and custom hollow metal frames and doors are manufactured in their New Mexico manufacturing plant from materials produced substantially in the United States and as such, meet the requirements of 41 U.S.C 10, commonly known as the Buy-American Act. In addition, all Rocky Mountain Metals, Inc. products meet the “Made in USA” standards set forth by the Federal Trade Commission (FTC) Act and Enforcement Policy Statement.



≡ National Association of Architectural Metal Manufacturers ≡

MEMBER

Rocky Mountain Metals, Inc.

140 Coal St. • Raton, New Mexico 87740

Phone: 575.445.2756 • Fax: 575.303.7069

info@rockymountainmetals.com

www.rockymountainmetals.com